

# Tickr<sup>®</sup>

MAKE YOUR HOME HAPPY



Luxurious  
Architectural Hardware

PRODUCT CATALOGUE

# Tickr®

MAKE YOUR HOME HAPPY

Tickr - world-class Architectural Hardware Company surpassed all proven bench marks. It is our track record which place us as a front-runner amongst vast variety of hardware products. In a decade, real estate has emerged as a remarkable player in terms of modernity, style and durability. Demand for quality material was essence of the time. Inferior or short-term material providers have been eliminated completely and only those player survived in this fierce competition who gave tough competition to their opponents. At Tickr, our exponential growth is the proof of our commitment, strength, confidence of customer. we can proudly say that we have retained our position as one of the big leader of architectural hardware.

Let's look at our endeavors:

Vast product range -Floor spring, Patch fitting, Shower hinges, Glass Connectors, Sliding fitting, Door handles, Spider fitting, Railing accessories, Glass door locks, Aluminium track, Kitchen profiles etc.

- While sourcing raw material, we undergo meticulous planning at every stage such as latest trends in the market and how to overcome embarrassing situations of non-performance.

Always looking for newer products and quality

- Thorough inspection and stringent quality tests

- Service and support : Quick reaction, post Service support

Last but not the least, we have established confidence with our elite clients



# Tickr®

## MAKE YOUR HOME HAPPY

Floor Spring	01-02
Combo Patch Set	03
Hydraulic Patch	04
Patch Fitting	05-07
Plastic Profile	08
Sower Hinges	09-10
Glass Connectors	11-12
Hydraulic Shower Hinges	13
Sower Knight Head Acc.	14
Sower Door Knobs & Handles	15
Canopy Fitting & Point Fixed Glass Connectors	15
Shower Sliding System 11A	16
Office Sliding System & Acc.	17-18
Sliding Shower Screen System Set	19
Office Sliding System	20
Sliding Folding System	21
Center Sliding Folding System	22
Profile Telescopic Sliding System	23
Profile Synchronized Sliding System	24
Automatic Sliding Sensor Door	25
Spider Fitting	26-27
Articulated Routels	27
Fin Plates & Splice Plates	28
Door Handels	29-31
Door Locks	32-33
Glass Railing Acc.	34-35
Aluminium Track	36
Tandom Box	37
Aluminium Kitchen Profile	38
Wardrobe Sliding System	39
Auto Closing Hinges	39
Telescopin Channel	40



Tickr®

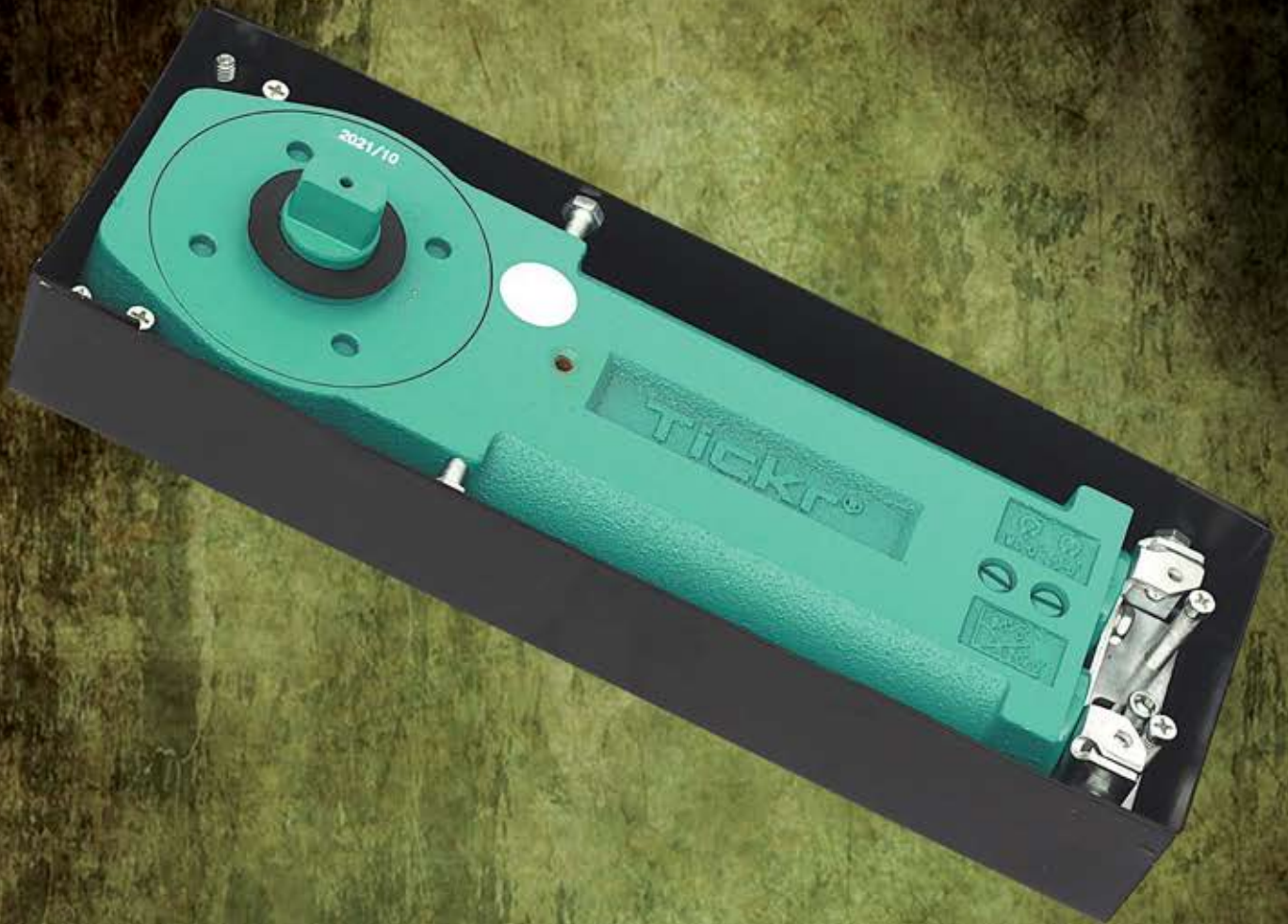
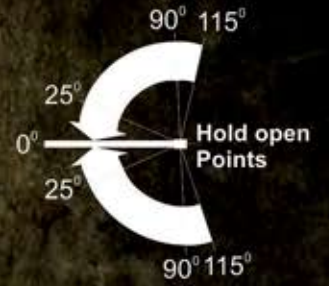

TCH-8400

Double Spring Floor Hinge

TESTED TO  
**5,00,000 CYCLES**



**Specification**

Over 5,00,000 cycles tested.  
General design, suitable for left or right hand to open the door in single and both sides.  
Universal machine cylinder.  
Closing force-25nm.  
Maximum wide door leaf-1100mm.  
Maximum door weight-120kgs  
Speed covering control-two stage adjustable speed.  
Location-90° hold open

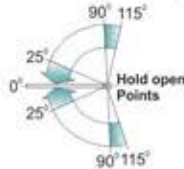
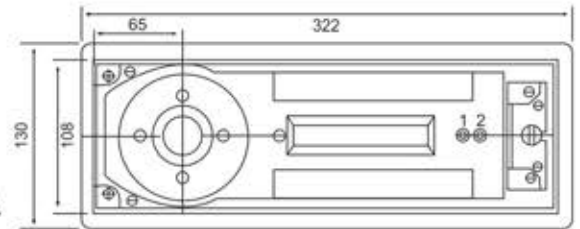

**TCH-8400**  
Double Spring Floor Hinge

**TCH-8400 BM**  
Double Spring Floor Hinge

**TCH-8400 GD**  
Double Spring Floor Hinge

**TCH-8400 RG**  
Double Spring Floor Hinge



**Specification**

Over 5,00,000 cycles tested.  
General design, suitable for left or right hand to open the door in single and both sides.  
Universal machine cylinder.  
Closing force-20nm.  
Maximum wide door leaf-750 to 900mm.  
Maximum door weight-90kgs  
Speed covering control-two stage adjustable speed.  
Location-90° hold open

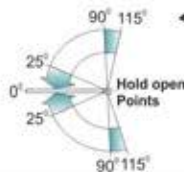
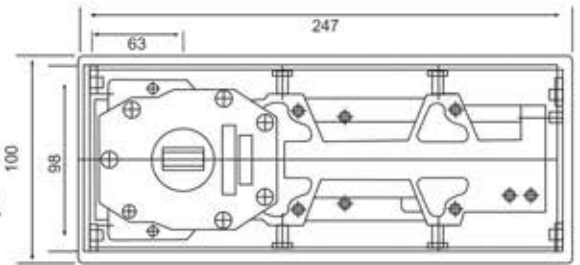

**TCH-7400**  
Single Spring Floor Hinge

**TCH-7400 BM**  
Double Spring Floor Hinge

**TCH-7400 GD**  
Double Spring Floor Hinge

**TCH-7400 RG**  
Double Spring Floor Hinge



**Specification**

Over 5,00,000 cycles tested.  
General design, suitable for left or right hand to open the door in single and both sides.  
Universal machine cylinder.  
Closing force-25nm.  
Maximum wide door leaf-1200mm.  
Maximum door weight-150kgs  
Speed covering control-two stage adjustable speed.  
Location-90° hold open

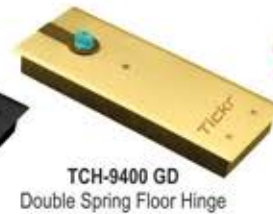
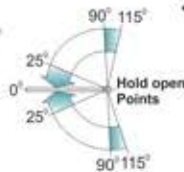
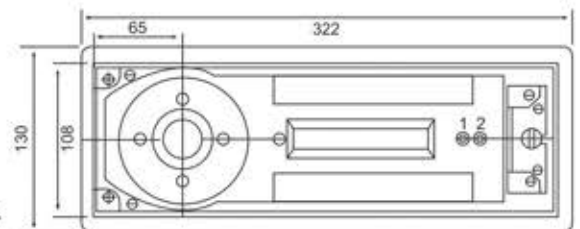

**TCH-9400**  
Double Spring Floor Hinge

**TCH-9400 BM**  
Double Spring Floor Hinge

**TCH-9400 GD**  
Double Spring Floor Hinge

**TCH-9400 RG**  
Double Spring Floor Hinge

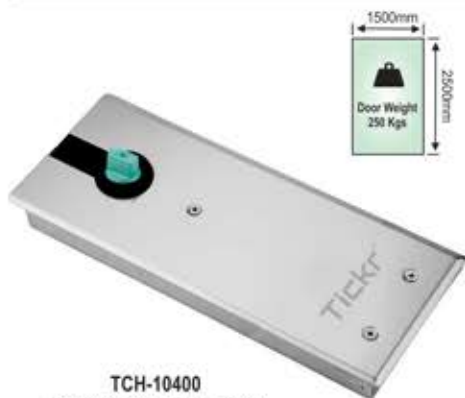

**Specification**

Over 5,00,000 cycles tested.  
General design, suitable for left or right hand to open the door in single and both sides.  
Universal machine cylinder.  
Closing force-25nm.  
Maximum wide door leaf-1500mm.  
Maximum door weight-200kgs  
Speed covering control-two stage adjustable speed.  
Location-90° hold open

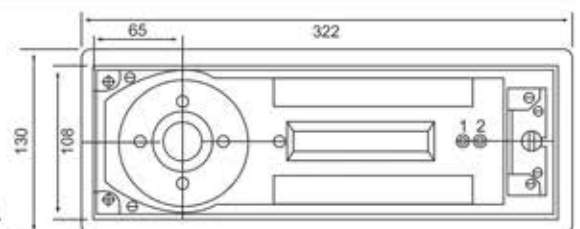

**TCH-10400**  
Double Spring Floor Hinge



**TCH-8400 (Set- 5 Pcs.)**  
Double Spring Floor Hinge  
Top Patch, Bottom Patch,  
Corner Patch Lock, Top Pivot



**TCH-001**  
Top Patch



**TCH-002**  
Bottom Patch



**TCH-8407**  
Corner Patch Lock



**TCH-8405**  
Top Pivot



**TCH-8400 B (Set- 5 Pcs.)**  
Double Spring Floor Hinge  
Top Patch, Bottom Patch,  
Corner Patch Lock, Top Pivot



**TCH-001 BM**  
Top Patch



**TCH-002 BM**  
Bottom Patch



**TCH-8407 BM**  
Corner Patch Lock



**TCH-8405 BM**  
Top Pivot



**TCH-8400 G (Set- 5 Pcs.)**  
Double Spring Floor Hinge  
Top Patch, Bottom Patch,  
Corner Patch Lock, Top Pivot



**TCH-001 GD**  
Top Patch



**TCH-002 GD**  
Bottom Patch



**TCH-8407 GD**  
Corner Patch Lock



**PTCH-8405 GD**  
Top Pivot



**TCH-8400 RG (Set- 5 Pcs.)**  
Double Spring Floor Hinge  
Top Patch, Bottom Patch,  
Corner Patch Lock, Top Pivot



**TCH-001 RG**  
Top Patch



**TCH-002 RG**  
Bottom Patch



**TCH-8407 RG**  
Corner Patch Lock



**TCH-8405 RG**  
Top Pivot



**TCH-7400 (Set- 5 Pcs.)**  
Double Spring Floor Hinge  
Top Patch, Bottom Patch,  
Corner Patch Lock, Top Pivot



**TCH-001**  
Top Patch



**TCH-002**  
Bottom Patch



**TCH-8407**  
Corner Patch Lock



**TCH-8405**  
Top Pivot



**TCH-7400 B (Set- 5 Pcs.)**  
Double Spring Floor Hinge  
Top Patch, Bottom Patch,  
Corner Patch Lock, Top Pivot



**TCH-001 BM**  
Top Patch



**TCH-002 BM**  
Bottom Patch



**TCH-8407 BM**  
Corner Patch Lock



**TCH-8405 BM**  
Top Pivot



**TCH-7400 (Set- 5 Pcs.)**  
Double Spring Floor Hinge  
Top Patch, Bottom Patch,  
Corner Patch Lock, Top Pivot



**TCH-001 GD**  
Top Patch



**TCH-002 GD**  
Bottom Patch



**TCH-8407 GD**  
Corner Patch Lock



**TCH-8405 GD**  
Top Pivot



**TCH-7400 B (Set- 5 Pcs.)**  
Double Spring Floor Hinge  
Top Patch, Bottom Patch,  
Corner Patch Lock, Top Pivot



**TCH-001 RG**  
Top Patch



**TCH-002 RG**  
Bottom Patch



**TCH-8407 RG**  
Corner Patch Lock



**TCH-8405 RG**  
Top Pivot



**TCH-9400 (Set- 5 Pcs.)**  
Double Spring Floor Hinge  
Top Patch, Bottom Patch,  
Corner Patch Lock, Top Pivot



**TCH-001**  
Top Patch



**TCH-002**  
Bottom Patch



**TCH-8407**  
Corner Patch Lock



**TCH-8405**  
Top Pivot



**TCH-9400 B (Set- 5 Pcs.)**  
Double Spring Floor Hinge  
Top Patch, Bottom Patch,  
Corner Patch Lock, Top Pivot



**TCH-001 BM**  
Top Patch



**TCH-002 BM**  
Bottom Patch



**TCH-8407 BM**  
Corner Patch Lock



**TCH-8405 BM**  
Top Pivot



**TCH-9400 (Set- 5 Pcs.)**  
Double Spring Floor Hinge  
Top Patch, Bottom Patch,  
Corner Patch Lock, Top Pivot



**TCH-001 GD**  
Top Patch



**TCH-002 GD**  
Bottom Patch



**TCH-8407 GD**  
Corner Patch Lock



**TCH-8405 GD**  
Top Pivot



**TCH-9400 B (Set- 5 Pcs.)**  
Double Spring Floor Hinge  
Top Patch, Bottom Patch,  
Corner Patch Lock, Top Pivot



**TCH-001 RG**  
Top Patch



**TCH-002 RG**  
Bottom Patch



**TCH-8407 RG0**  
Corner Patch Lock



**TCH-8405 RG**  
Top Pivot

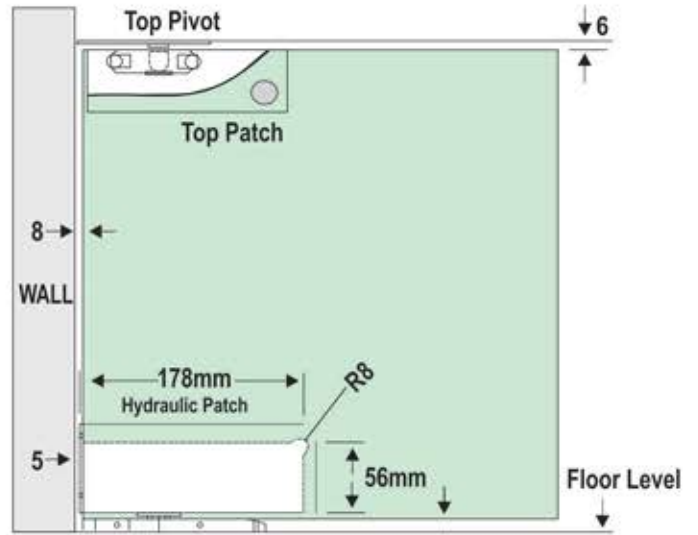
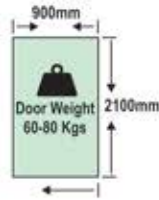

**TCH-100**  
Hydraulic Floor Hinge

**Product Specification**

- Suitable door weight : Max 80kg
- Suitable door width : 750-900mm
- Suitable door height : 2100-2250mm
- Suitable door thickness : 8-12mm
- Ambient temperature : -20°C~+50°C
- Quick and easy installation

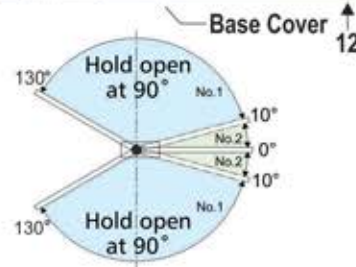
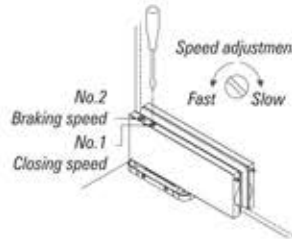

**TCH-100 BM**  
Hydraulic Floor Hinge



**TCH-100 GD**  
Hydraulic Floor Hinge



**TCH-100 RG**  
Hydraulic Floor Hinge

## HYDRAULIC PATCH SET



**TCH-100**  
Hydraulic Floor Hinge



**TCH-001**  
Top Patch



**TCH-8405**  
Top Pivot



**TCH-100 BM**  
Hydraulic Floor Hinge



**TCH-001 BM**  
Top Patch



**TCH-8405**  
Top Pivot



**TCH-100 GD**  
Hydraulic Floor Hinge



**TCH-001 GD**  
Top Patch



**TCH-8405**  
Top Pivot



**TCH-100 RG**  
Hydraulic Floor Hinge



**TCH-001 RG**  
Top Patch



**TCH-8405 RG**  
Top Pivot



**TCH-001**  
Top Patch

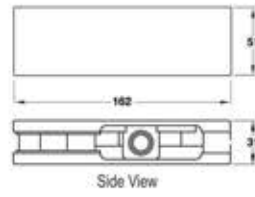
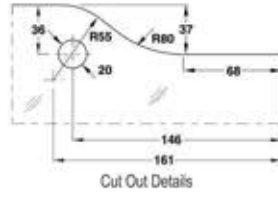

**TCH-001 BM**  
Top Patch



**TCH-001 GD**  
Top Patch



**TCH-001 RG**  
Top Patch



**TCH-002**  
Bottom Patch

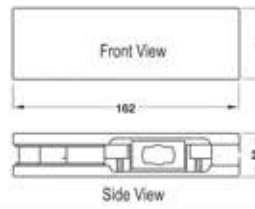
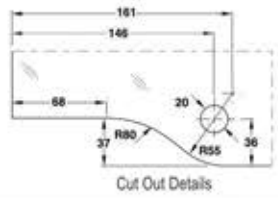

**TCH-002 BM**  
Bottom Patch



**TCH-002 GD**  
Bottom Patch



**TCH-002 RG**  
Bottom Patch



**TCH-8406**  
Over Panel Side Panel  
Connecting Patch with Pivot (Big L)

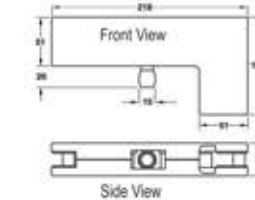
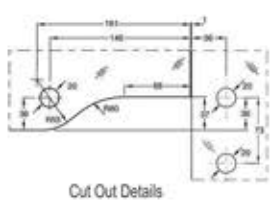

**TCH-8406 BM**  
Big L



**TCH-8406 GD**  
Big L



**TCH-8406 RG**  
Big L



**TCH-8407**  
Corner Patch Lock  
with Strike Plate

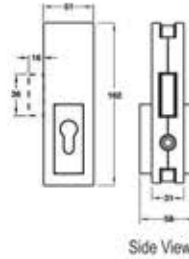
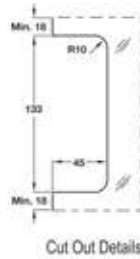

**TCH-8407**  
Corner Patch Lock  
with Strike Plate



**TCH-8407**  
Corner Patch Lock  
with Strike Plate



**TCH-8407**  
Corner Patch Lock  
with Strike Plate



**TCH-8408**  
Over Panel Side Panel  
Patch Connector (Small L)

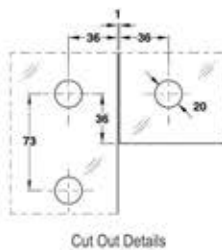

**TCH-8408**  
Small L



**TCH-8408**  
Small L



**TCH-8408**  
Small L



**TCH-8409**  
Wall Mounted Over Panel  
Patch with Pivot (Over Panel)

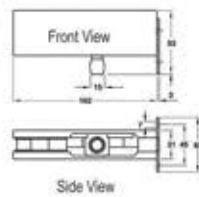
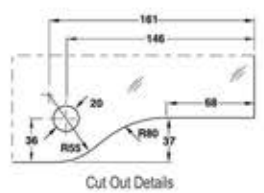

**TCH-8409**  
Over Panel Patch



**TCH-8409**  
Over Panel Patch



**TCH-8409**  
Over Panel Patch



**TCH-8405**  
Top Pivot for Patch Fitting Door

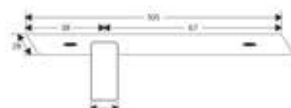

**TCH-8405**  
Top Pivot



**TCH-8405**  
Top Pivot



**TCH-8405**  
Top Pivot





**TCH-8410**  
Center Patch Lock

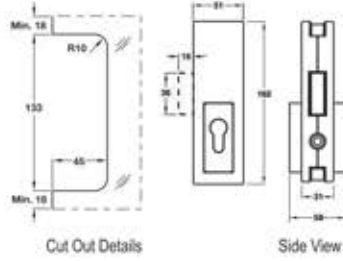

**TCH-8411**  
Center Lock Strike Box

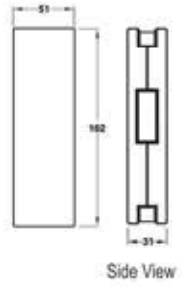

**TCH-8412**  
Latch Lock

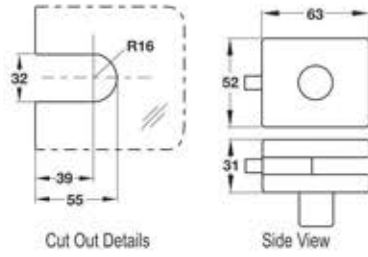

**TCH-8413**  
Latch Lock Strike Box

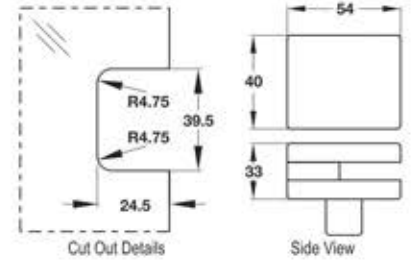

**TCH-8414**  
Quadruple Patch

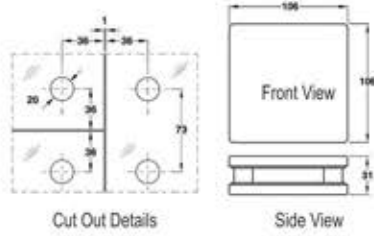

**TCH-8415**  
Wall to Glass Connecting Patch

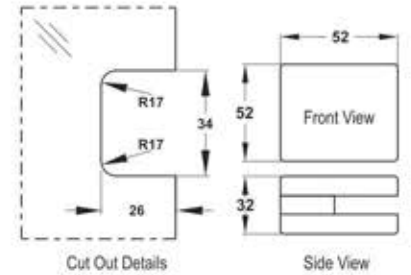

**TCH-8416**  
Glass to Glass Connecting Patch  
with Wall/ Ceiling

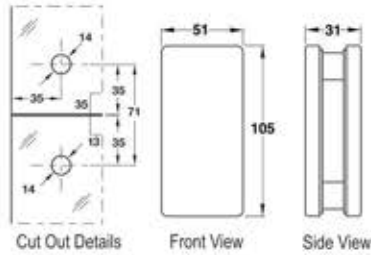

**TCH-8418**  
Double Over Panel Patch

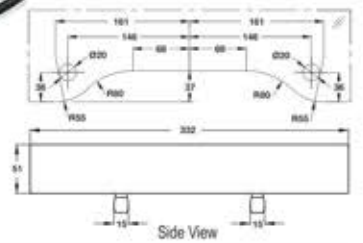

**TCH-8417**  
Wall to Glass Connecting Patch

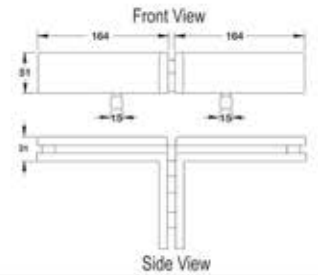
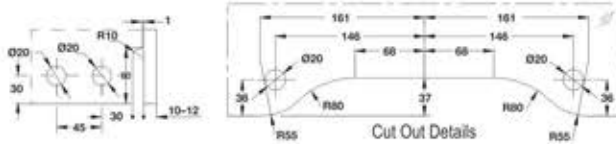

**TCH-8419**  
Over Panel Side Panel  
Connector with Fin (Left)

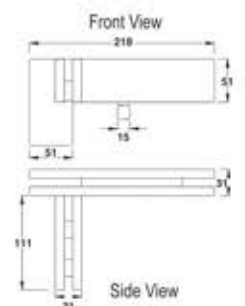
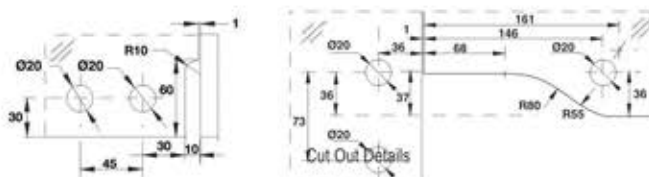



**TCH-8420**  
Over Panel Side Panel  
Connector with Fin (Right)

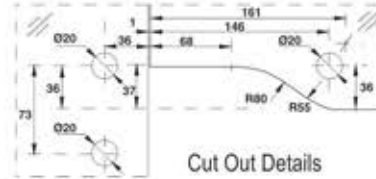
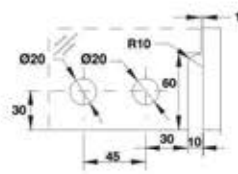

Cut Out Details

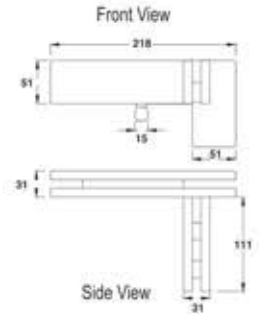

Side View



**TCH-8421**  
Connector with Fin

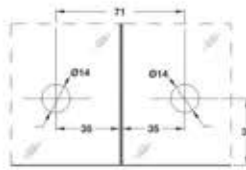

Cut Out Details

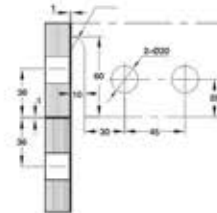

Cut Out Details

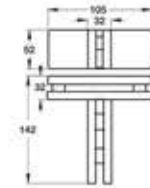

Side View



**TCH-8422**  
Quadruple Patch with Fin

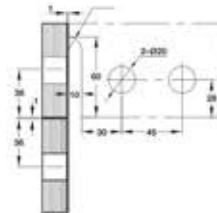
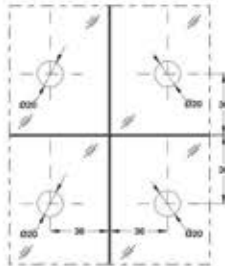

Cut Out Details

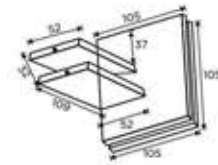

Side View



**TCH-8423**  
Triple Glass Patch Connector with Fin (Left/ Right)

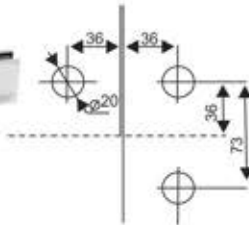

Cut Out Details

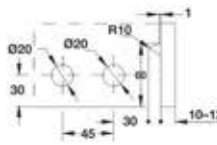

**TCH-8424**  
Over Panel Side Panel Patch  
Connector with Stopper

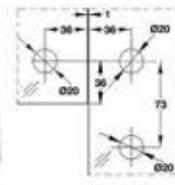

Cut Out Details

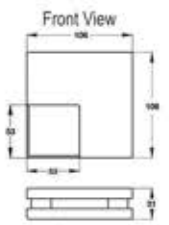

Side View



**TCH-8403**  
Top Pivot / Bottom Pivot for  
Wooden / Aluminium Doors



**TCH-8401**  
Mini Floor Hinge

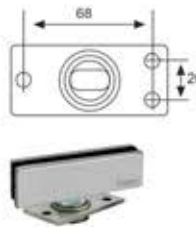

**TCH-8404**  
Glass Door Stopper

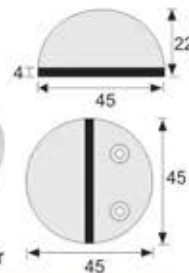

**TCH-8402**  
Glass Door Tower Bolt



Specification

- Finish : Satin stainless steel
- Pivot point of 55 / 65mm
- With SS 304 cover of 1.2mm thickness
- High quality tempered precision screws are used to ensure solid gripping

## TRANSPARENT PVC PROFILE

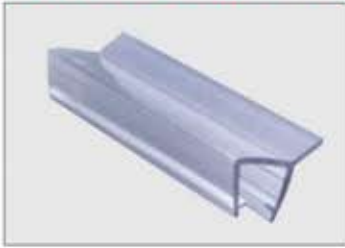

**TCH-8445 Wall Seal**  
For : 10-12mm Glass, Size : 2.2mtr.



**TCH-8446 Center Seal**  
For : 10-12mm Glass, Size : 2.2mtr. & 2.5mtr.

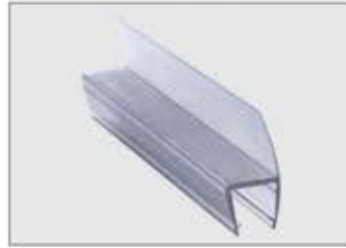

**TCH-8447 Side Seal**  
For : 10-12mm Glass, Size : 2.2mtr. & 2.5mtr.



**TCH-8448 D Seal**  
For : 10-12mm Glass, Size : 2.2mtr. & 2.5mtr.

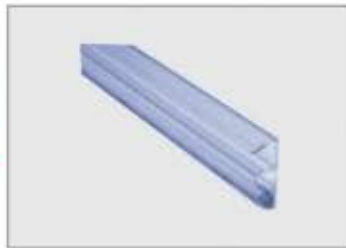

**TCH-8449**  
For : 10-12mm Glass, Size : 2.2mtr.



**TCH-8450 Sliding Door Seal**  
For : 10-12mm Glass, Size : 2.2mtr.



**TCH-8451 Water Dispersal Seal**  
For : 10-12mm Glass, Size : 2.2mtr.



**TCH-8452 Magnetic Seal 180°**  
For : 10-12mm Glass, Size : 2.2mtr.



**TCH-8453 Magnetic Seal 135°**  
For : 10-12mm Glass, Size : 2.2mtr.

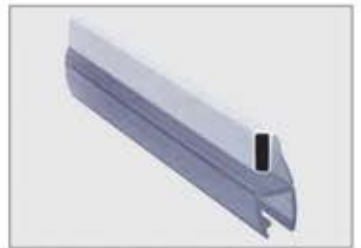

**TCH-8454 Magnetic Seal 90°**  
For : 10-12mm Glass, Size : 2.2mtr.

## Black PVC PROFILE

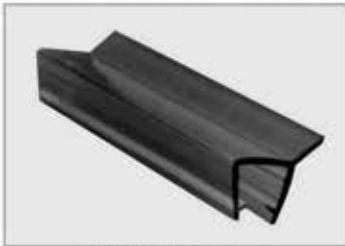

**TCH-8445 B Wall Seal**  
For : 10-12mm Glass, Size : 2.2mtr.



**TCH-8446 B Center Seal**  
For : 10-12mm Glass, Size : 2.2mtr. & 2.5mtr.

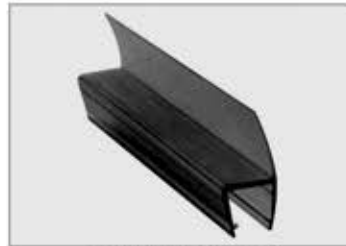

**TCH-8447 B Side Seal**  
For : 10-12mm Glass, Size : 2.2mtr. & 2.5mtr.



**TCH-8448 B D Seal**  
For : 10-12mm Glass, Size : 2.2mtr. & 2.5mtr.



**TCH-8449 B**  
For : 10-12mm Glass, Size : 2.2mtr.



**TCH-8450 B Sliding Door Seal**  
For : 10-12mm Glass, Size : 2.2mtr.

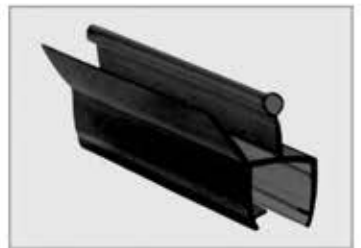

**TCH-8451 B Water Dispersal Seal**  
For : 10-12mm Glass, Size : 2.2mtr.



**TCH-8452 B Magnetic Seal 180°**  
For : 10-12mm Glass, Size : 2.2mtr.

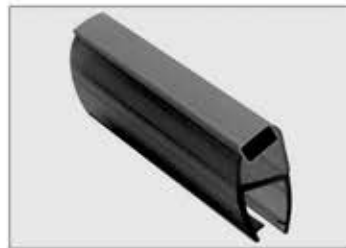

**TCH-8453 B Magnetic Seal 135°**  
For : 10-12mm Glass, Size : 2.2mtr.



**TCH-8454 B Magnetic Seal 90°**  
For : 10-12mm Glass, Size : 2.2mtr.

Door Thickness : 8mm-12mm  
Weight Cap. : 45kg  
Finish : Matt & Chrome Plated

### ECONOMY SERIES (ZINC)

### PREMIUM SERIES (SS 304)



**TCH-8425**  
Wall to Glass 90° Off Set Hinge



**TCH-8431**  
Wall to Glass 90° Off Set Hinge



**TCH-8431 BM**



**TCH-8431 GD**



**TCH-8431 RG**



**TCH-8426**  
Wall to Glass 90° Hinge



**TCH-8432**  
Wall to Glass 90° Hinge



**TCH-8432 BM**



**TCH-8432 GD**



**TCH-8432 RG**



**TCH-8427**  
Glass to Glass 180° Hinge



**TCH-8433**  
Glass to Glass 180° Hinge



**TCH-8433 BM**



**TCH-8433 GD**



**TCH-8433 RG**



**TCH-8428**  
Glass to Glass 135° Hinge



**TCH-8435**  
Glass to Glass 135° Hinge



**TCH-8435 BM**



**TCH-8435 GD**



**TCH-8435 RG**



**TCH-8429**  
Glass to Glass 90° Hinge



**TCH-8436**  
Glass to Glass 90° Hinge



**TCH-8436 BM**



**TCH-8436 GD**



**TCH-8436 RG**



**TCH-8430**  
Wall to Glass 90° Fix Bracket



**TCH-8437**  
Wall to Glass 90° Fix Bracket



**TCH-8437 BM**



**TCH-8437 GD**



**TCH-8437 RG**

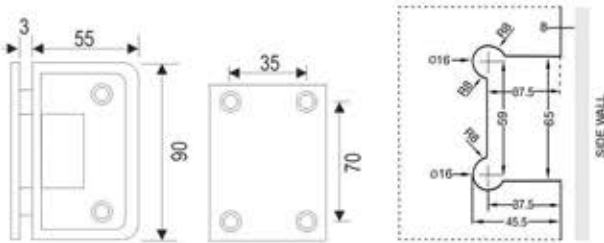

**Size & Cutout Details for TCH-8425 & TCH-8431**  
Wall to Glass 90° Off Set Hinge

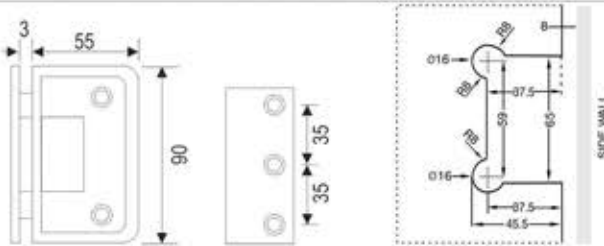

**Size & Cutout Details for TCH-8426 & TCH-8432**  
Wall to Glass 90° Hinge

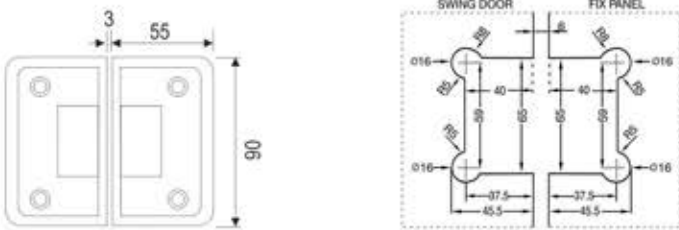

**Size & Cutout Details for TCH-8427 & TCH-8433**  
Glass to Glass 180° Hinge

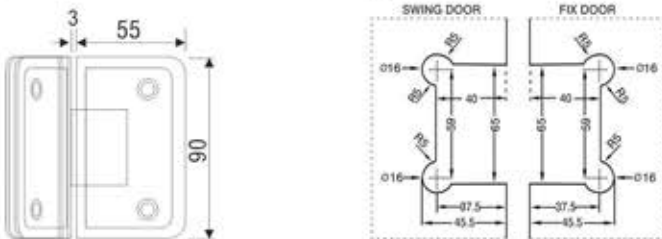
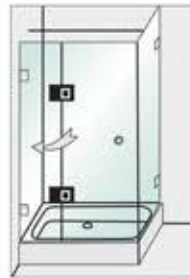

**Size & Cutout Details for TCH-84278 & TCH-8435**  
Glass to Glass 135° Hinge

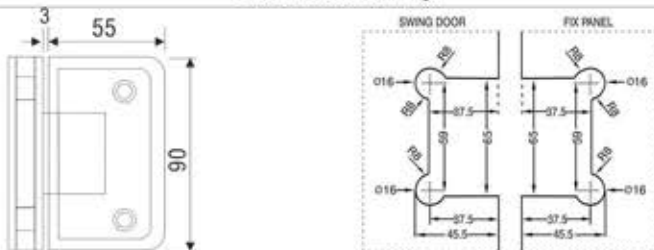

**Size & Cutout Details for TCH-8429 & TCH-8436**  
Glass to Glass 90° Hinge

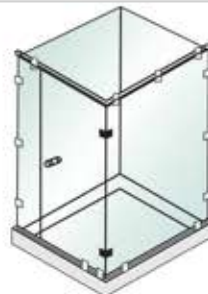

**Size & Cutout Details for TCH-8430 & TCH-8437**  
Wall to Glass 90° Fix Bracket



Door Thickness : 8mm-12mm  
 Weight Cap. : 45kg  
 Finish : Matt & Chrome Plated

### PREMIUM SERIES (SS 304)

### ROYAL SERIES (SS 304)

### ROUND SERIES (SS 304)



TCH-8438  
U Connector



TCH-8438 BM BM  
U Connector



TCH-8438 GD  
U Connector



TCH-8438 RG  
U Connector



TCH-8438 A  
U Connector



TCH-8438 R  
U Connector



TCH-8439  
Glass to Glass 135° Connector



TCH-8439 BM



TCH-8439 GD



TCH-8439 RG



TCH-8439 A  
Glass to Glass 135° Connector



TCH-8439 R  
Glass to Glass 135° Connector



TCH-8440  
Glass to Glass 90° Connector



TCH-8440 BM



TCH-8440 GD



TCH-8440 RG



TCH-8440 A  
Glass to Glass 90° Connector



TCH-8440 R  
Glass to Glass 90° Connector



TCH-8442  
L Connector



TCH-8442 BM



TCH-8442 GD



TCH-8442 RG



TCH-8442 A  
L Connector



TCH-8442 R  
L Connector



TCH-8443  
Glass to Glass 180° Connector



TCH-8443 BM



TCH-8443 GD



TCH-8443 RG



TCH-8443 A  
Glass to Glass 180° Connector



TCH-8443 R  
Glass to Glass 180° Connector



TCH-8443  
T Connector Glass to Glass 90°



TCH-8443 BM



TCH-8443 GD



TCH-8443 RG

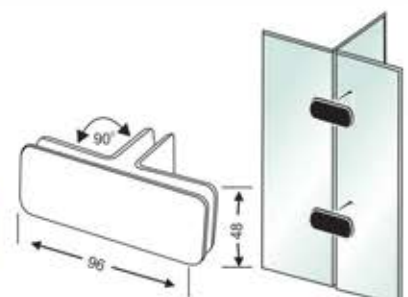

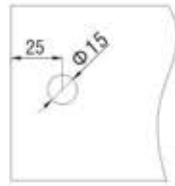
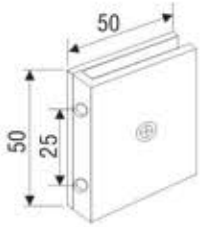

Size & Cutout Details for TCH-8438, TCH-8438 A & TCH-8438 R  
U Connector

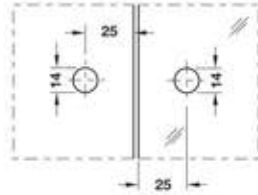
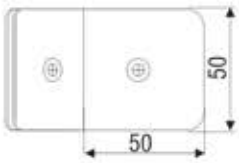

Size & Cutout Details for TCH-8439, TCH-8439 A & TCH-8439 R  
Glass to Glass 135° Connector

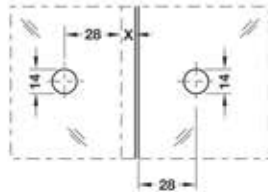
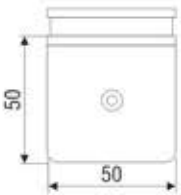

Size & Cutout Details for TCH-8440, TCH-8440 A & TCH-8440 R  
Glass to Glass 90° Connector

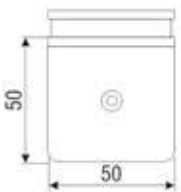

Size & Cutout Details for TCH-8442, TCH-8442 A & TCH-8442 R  
L Connector

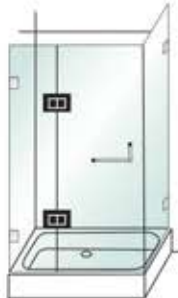
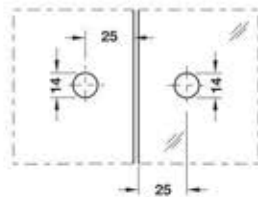
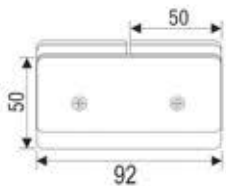

Size & Cutout Details for TCH-8443, TCH-8443 A & TCH-8443 R  
Glass to Glass 180° Connector



TCH-8434  
Double Glass T Hinge (SS 304)



TCH-8434 BM



TCH-8434 GD



TCH-8434 RG

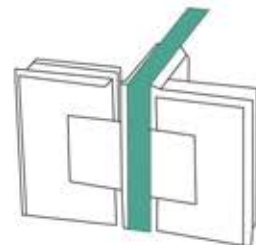



**TCH-8805**  
Wall to Glass Hinge 90°



**TCH-8805 BM**  
Wall to Glass Hinge 90°

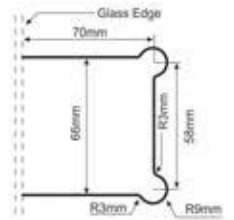
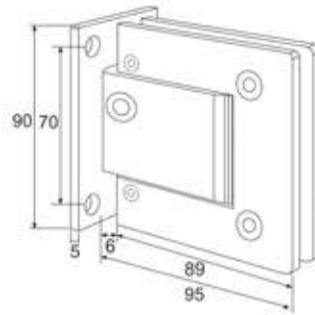

**TCH-8806**  
Glass to Glass Hinge 180°



**TCH-8806 BM**  
Glass to Glass Hinge 180°

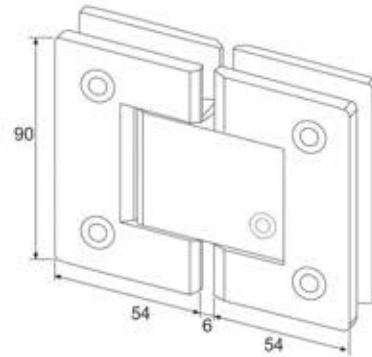



## ROUND SERIES DIA-19mm (SS 304)



**TCH-8455**  
Wall to Rod



**TCH-8455 BM**   **TCH-8455 GD**   **TCH-8455 RG**



**TCH-8456**  
Rod to Glass



**TCH-8456 BM**   **TCH-8456 GD**   **TCH-8456 RG**



**TCH-8457**  
Rod to Rod



**TCH-8457 BM**   **TCH-8457 GD**   **TCH-8457 RG**



**TCH-8458**  
Rod to Glass  
(One Side Blind)



**TCH-8458 BM**   **TCH-8458 GD**   **TCH-8458 RG**



**TCH-8459**  
Rod to Rod T Connector



**TCH-8459 BM**   **TCH-8459 GD**   **TCH-8459 RG**

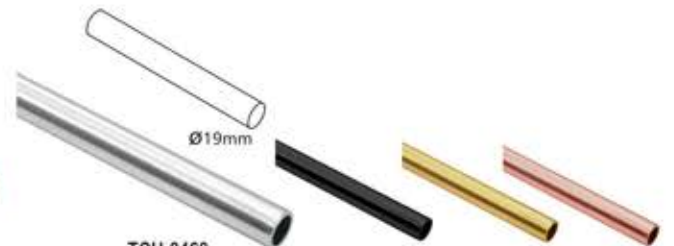

**TCH-8468**  
Reinforcing Rod (Dia 19mm)

**TCH-8468 BM**   **TCH-8468 GD**   **TCH-8468 RG**

## SQUARE SERIES DIA-25mm (SS 304)



**TCH-8460**  
Wall to Rod



**TCH-8461**  
Rod to Glass



**TCH-8462**  
Rod to Rod



**TCH-8462 A**  
Rod to Glass  
(One Side Blind)



**TCH-8463**  
Rod to Rod T Connector



**TCH-8469**  
Reinforcing Rod (Dia 25mm)



**TCH-8460**  
Wall to Track Connector



**TCH-8460**  
Track to Glass Connector



**TCH-8466**  
Track to Track Connector



**TCH-8470**  
Connecting Track  
(Available in 1.5mtr. & 2.1 mtr.)

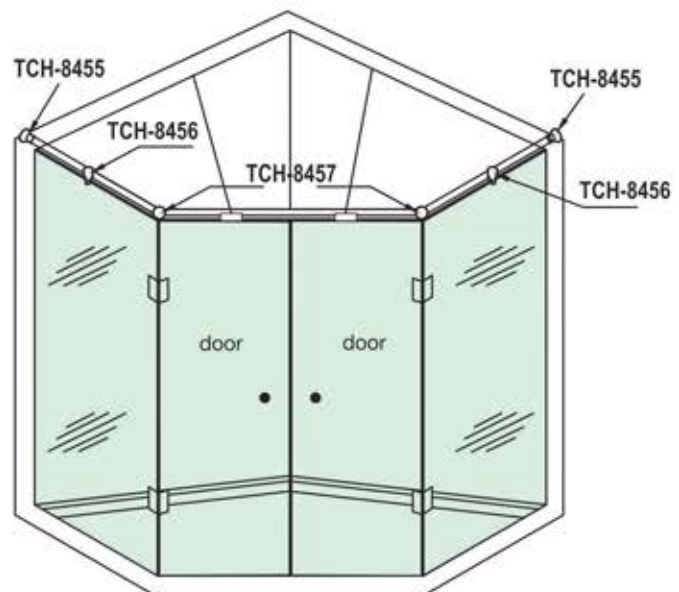



**TCH-8574**  
Door Knobs



**TCH-8575**  
Door Knobs



**TCH-84576**  
Door Knobs



**TCH-8577**  
Door Knobs

## SHOWER DOOR HANDLES



**TCH-8554**

SIZE
19x152x457CC
25x152x457CC



**TCH-8554 BM**



**TCH-8554 GD**



**TCH-8554 RG**



**TCH-8555**

SIZE
15/30x152x457

## CANOPY FITTING



**TCH-8516**  
Wall to Glass Connector

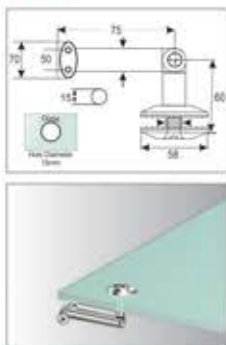

**TCH-8517**  
Rod to Glass Connector

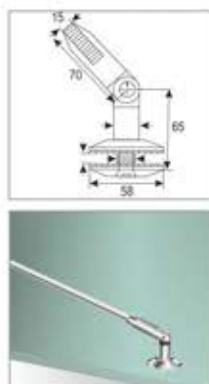

**TCH-8518**  
Wall to Rod Connector

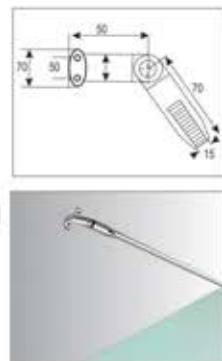

**TCH-8519 (16mm)**  
Canopy Rod with Thread

## POINT FIXED GLASS CONNECTORS



**TCH-8839**  
Wall to Glass (Adjustable)  
(Available in 82mm & 103mm)



**TCH-8840**  
Wall to Glass (Fix)  
(Available in 82mm & 103mm)



**TCH-8841**  
Glass to Glass (Adjustable)  
(Available in 82mm & 103mm)



**TCH-8842**  
Glass to Glass (Adjustable with Fin)  
(Available in 82mm & 103mm)



**CP Finish**

TCH-8482- 2 Big Roller & 2 Small Roller, TCH-8483 - 2 Track to Glass Holder  
 TCH-8484 - 2 Stopper, TCH-8485 - 1 Floor Guide  
 TCH-8486 - 2 Wall to Track Connector, TCH-8504 - 1 Sliding Handle



**Black Matt Finish**

TCH-8482- 2 Big Roller & 2 Small Roller, TCH-8483 - 2 Track to Glass Holder  
 TCH-8484 - 2 Stopper, TCH-8485 - 1 Floor Guide  
 TCH-8486 - 2 Wall to Track Connector, TCH-8504 - 1 Sliding Handle



**Gold Finish**

TCH-8482- 2 Big Roller & 2 Small Roller, TCH-8483 - 2 Track to Glass Holder  
 TCH-8484 - 2 Stopper, TCH-8485 - 1 Floor Guide  
 TCH-8486 - 2 Wall to Track Connector, TCH-8504 - 1 Sliding Handle



**Rose Gold Finish**

TCH-8482- 2 Big Roller & 2 Small Roller, TCH-8483 - 2 Track to Glass Holder  
 TCH-8484 - 2 Stopper, TCH-8485 - 1 Floor Guide  
 TCH-8486 - 2 Wall to Track Connector, TCH-8504 - 1 Sliding Handle

## SLIDING TRACK 11A



**TCH-8470**  
Connecting Track



**TCH-8470 BM**  
Connecting Track



**TCH-8470 GD**  
Connecting Track



**TCH-8470 RG**  
Connecting Track

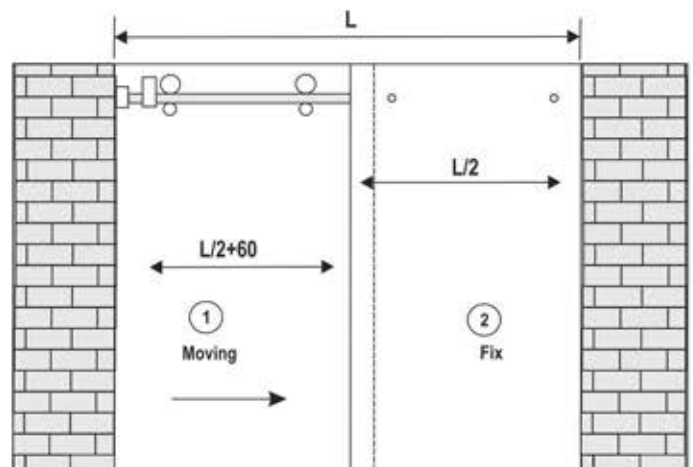
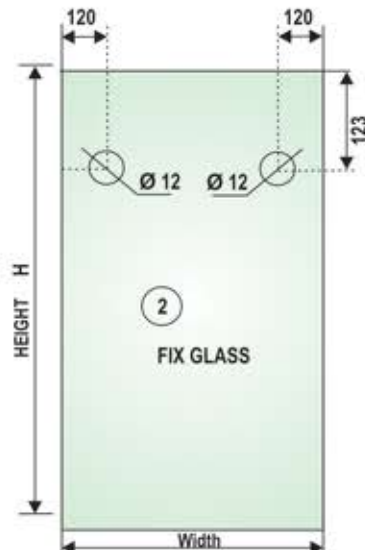
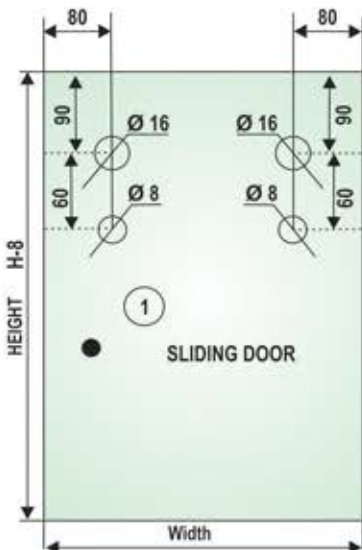

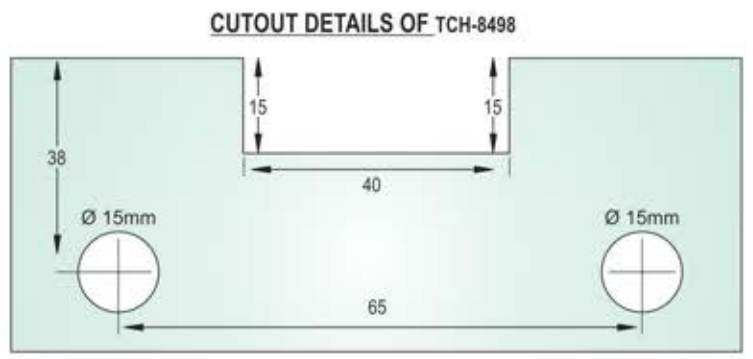
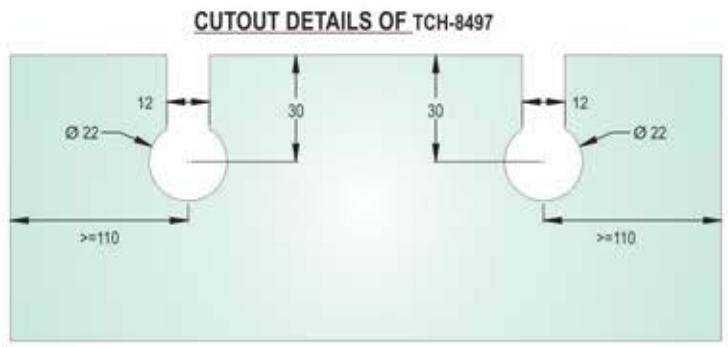
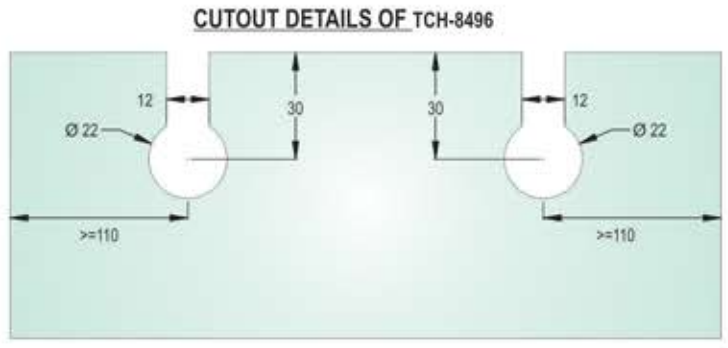



**TCH-8499**  
Stopper

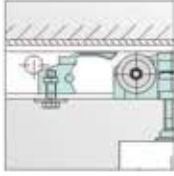

**TCH-8500**  
Wall to Track Clamp

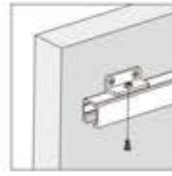

**TCH-8501**  
Glass to Track Clamp



**TCH-8502**  
90° Track Connector



**TCH-8503**  
Wall to Track Connector



**TCH-8504**  
Sliding Handle (Dia 50mm)



**TCH-8504 BM**

**TCH-8501GD**

**TCH-8504 RG**



**TCH-8505 (Hollow)**  
Sliding Handle (Dia 50mm)



**TCH-8506**  
Sliding Handle (Square)

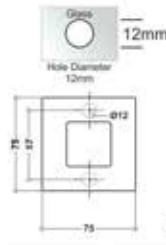

**TCH-8507**  
Sliding Handle (Rectangle)

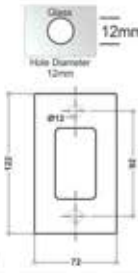

**TCH-8508**  
Sliding Door Lock  
with Strike Plate

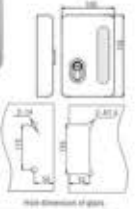

**TCH-8509**  
Sliding Door Lock



**TCH-8510**  
Strike Box

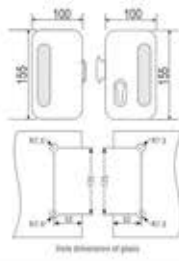

**TCH-8511**  
Floor Guide

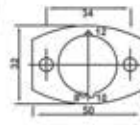

**TCH-8511 BM**



**TCH-8511 GD**



**TCH-8511 RG**



**TCH-8512**  
Aluminium Track (Single)  
Available in 8, 10 & 13 Ft.

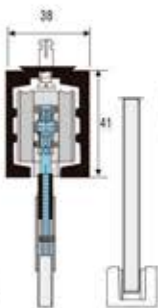

**TCH-8512 BM**



**TCH-8512 GM**



**TCH-8512 RG**



**TCH-8513**  
Aluminium Track (Double Door)  
Available in 8, 10 & 13 Ft.

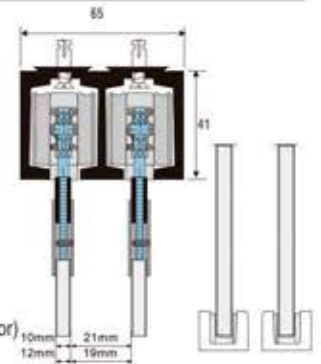

**TCH-8514**  
Aluminium Track (Door+Fix Glass)  
Available in 8, 10 & 13 Ft.

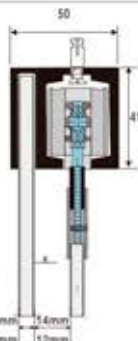

**TCH-8514 BM**



**TCH-8514 GM**



**TCH-8514 RG**



**TCH-8515**  
Cover for B-1 Track

Features : Sliding Door Weight: 50kg Max.  
Sliding Door Size: 750x2000mm Max.  
Glass Thickness: 8 to 10mm



**TCH-8800**  
Knob Clamp Roller (SS)



**TCH-8801**  
Track Mounting Bracket



**TCH-8802**  
Door Stopper



**TCH-8511**  
Floor Guide



**TCH-8803**  
Track to Track 90° Bracket (Extra)



**TCH-8800 BM**  
Knob Clamp Roller (SS)



**TCH-8801 BM**  
Track Mounting Bracket



**TCH-8802 BM**  
Door Stopper



**TCH-8511 BM**  
Floor Guide



**CH-8803 BM**  
Track to Track 90° Bracket (Extra)



**TCH-8800 GD**  
Knob Clamp Roller (SS)



**TCH-8801 GD**  
Track Mounting Bracket



**TCH-8802 GD**  
Door Stopper



**TCH-8511 GD**  
Floor Guide



**CH-8803 GD**  
Track to Track 90° Bracket (Extra)



**TCH-8800 RG**  
Knob Clamp Roller (SS)



**TCH-8801 RG**  
Track Mounting Bracket



**TCH-8802 RG**  
Door Stopper



**TCH-8511 RG**  
Floor Guide



**CH-8803 RG**  
Track to Track 90° Bracket (Extra)

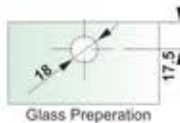

**TCH-8804**  
Top Track



**TCH-8804 BM**  
Top Track



**TCH-8804 GD**  
Top Track



**TCH-8804 RG**  
Top Track





**TCH-8491**  
Office Sliding Roller

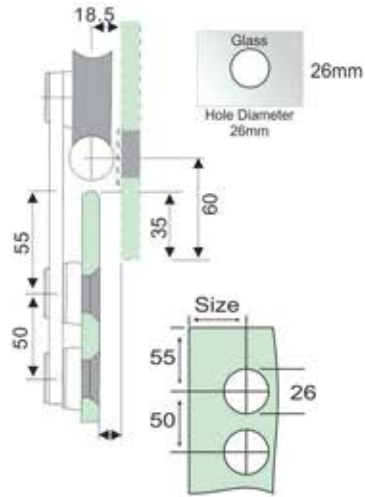

Ø 25mm  
**TCH-8495**  
Shower Sliding Pipe



**TCH-8487**  
Wall to Rod Holder



**TCH-8488**  
Glass to Rod Clamp



**TCH-8489**  
Floor Guide



**TCH-8490**  
Door Stopper



**TCH-8493**  
Wall to Rod Clamp

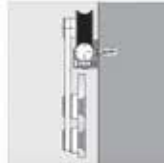

**TCH-8494**  
Glass to Glass Connector 180°

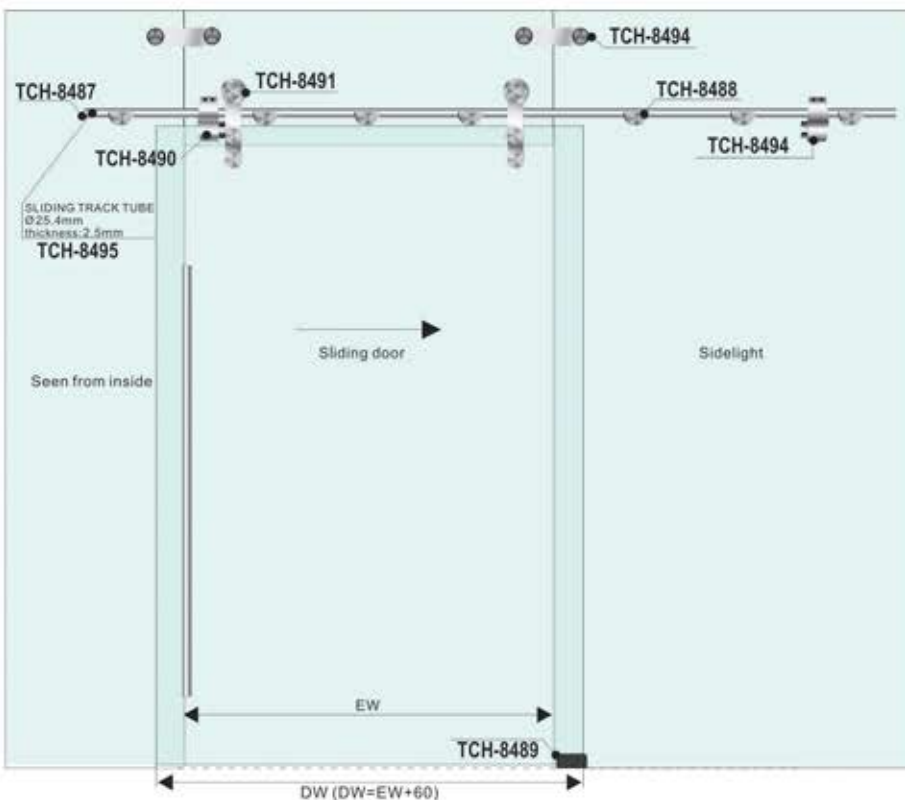

Track for sliding folding door system to be mounted to the ceiling and floor

Maximum weight per door : 70kg  
Maximum height per door : 2500mm

Maximum width per door : 900mm  
Suitable for 8 to 10mm glass thickness



**TCH-8807**  
Fixed Hinge



**TCH-8808**  
Glass to Glass Center Hinge



**TCH-8809**  
Center Hinge with Roller



**TCH-8810**  
End Hinge with Roller



**TCH-8811**  
Floor Fixed Hinge



**TCH-8812 L/R**  
Glass to Glass Center Hinge with Lock



**TCH-8813**  
Glass to Glass Center Hinge with Guide



**TCH-8814**  
End Hinge with Guide



**TCH-8815**  
Wall to Glass Hinge

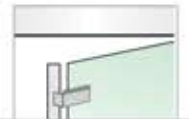

**TCH-8816**  
Floor Track Bottom (S.S.)



**TCH-8812**  
Aluminium Track (Top)

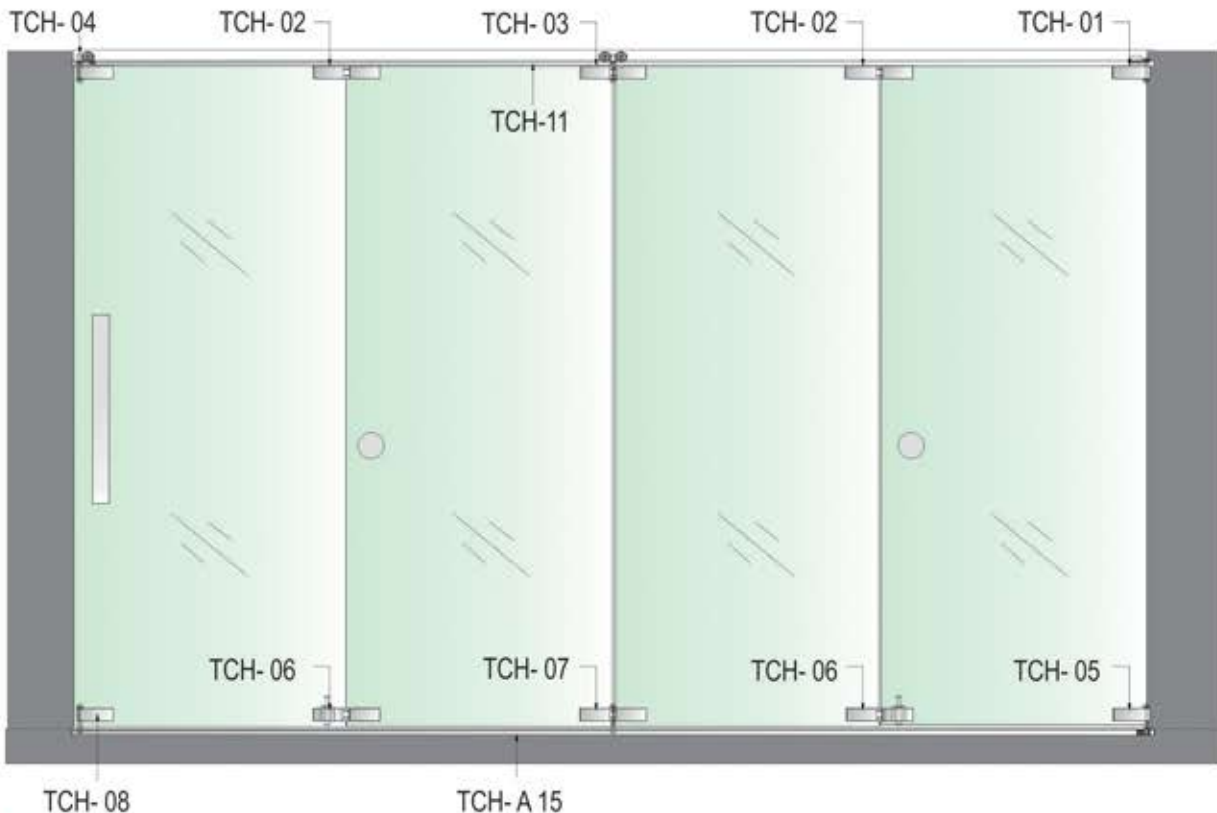
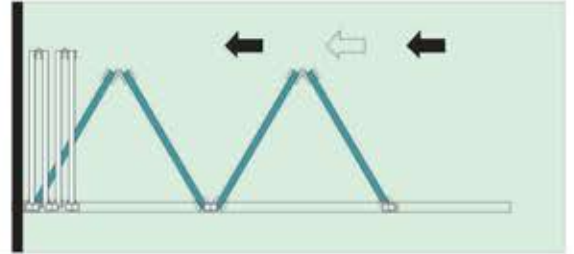





**TCH-8497**  
Folding Door Roller

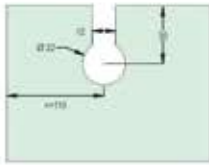

**TCH-8817**  
Glass to Wall Hinge

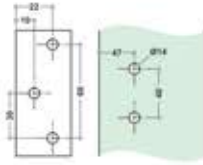

**TCH-8818**  
Glass to Glass Hinge

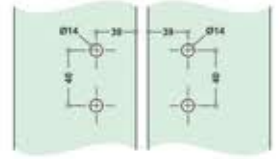

**TCH-8819**  
Glass Door Knob



**TCH-8820**  
Knob Sleeve



**TCH-8512**  
Aluminium Track  
Available in 4 Mt.

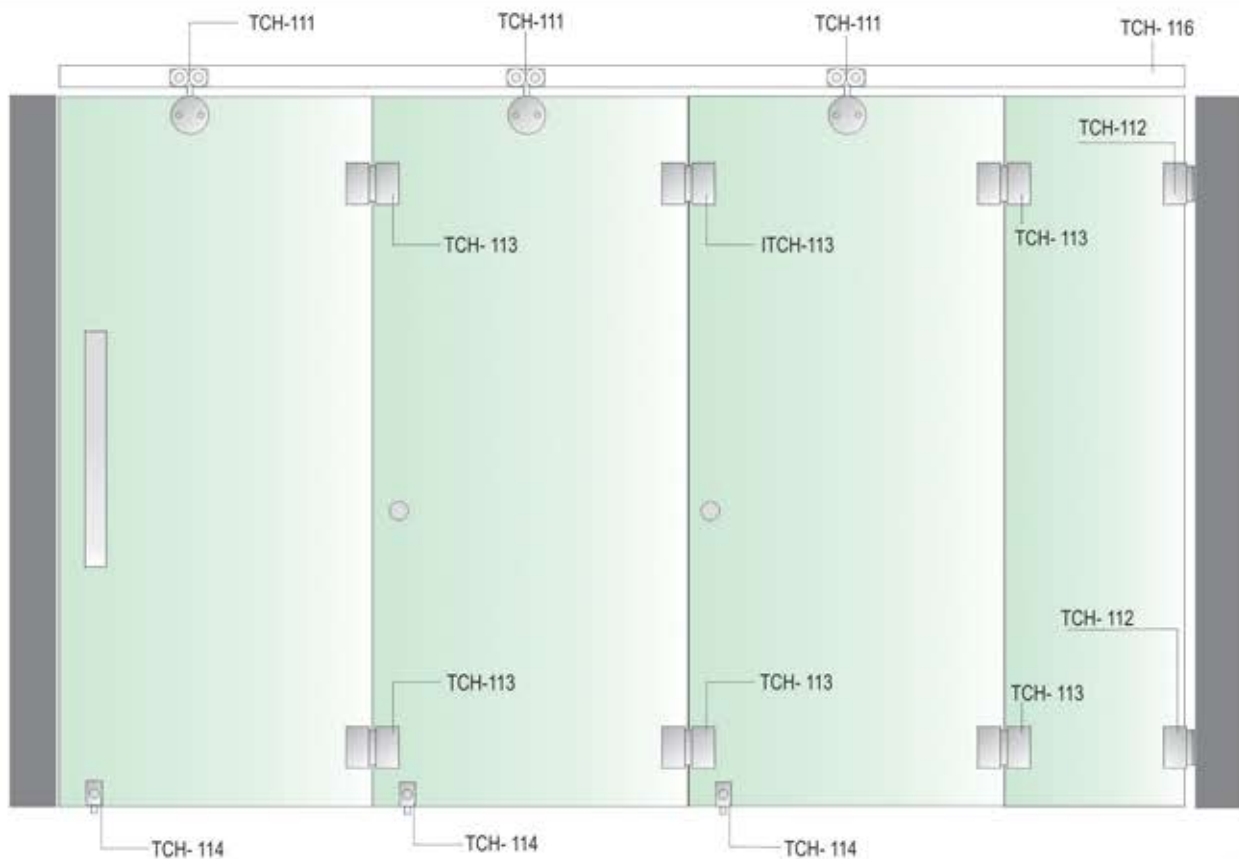
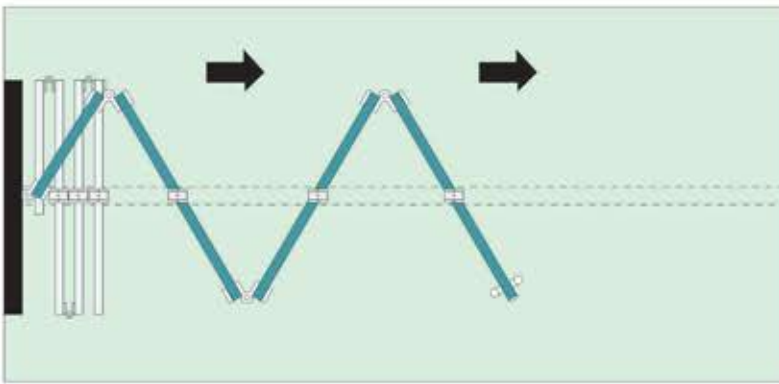

### Features

- Telescopic Sliding System for Three Doors, Two Doors and Single Door.
- Suitable for Sliding Doors for Homes, Hotels, Office Buildings etc.
- Space Saving, Good Decorative .
- Sliding Track: Aluminium Anodized.
- Hanging Roller: Zinc Alloy, SN.



**TCH-8821**  
Telescopic Sliding System

### 3+1 Telescopic System

- 3 Door Telescopic Accessories Set.
- Sliding Top Track.
- Track Decorative Cover .
- Top & Bottom Profile.
- Side Profile.
- Handles.
- Divider Profile as Per Requirement.

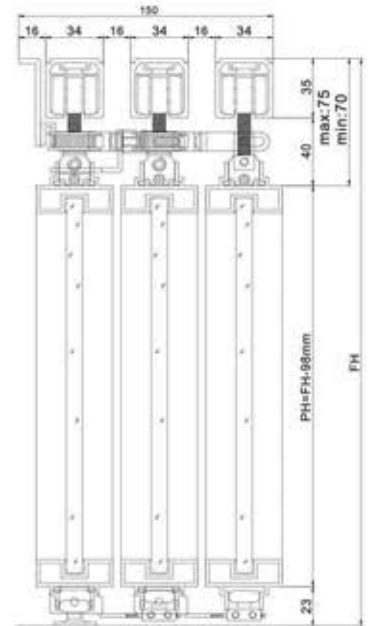

**TCH-8822**  
Telescopic Sliding System

### 2+1 Telescopic System

- 2 Door Telescopic Accessories Set.
- Sliding Top Track.
- Track Decorative Cover .
- Top & Bottom Profile.
- Side Profile.
- Handles.
- Divider Profile as Per Requirement.

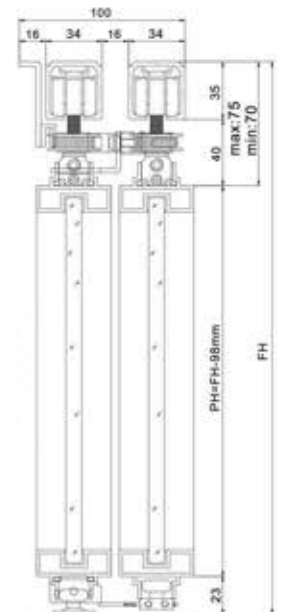

**TCH-8823**  
Telescopic Sliding System

### Single Door Sliding System

- Single Door Telescopic Accessories Set.
- Sliding Top Track.
- Track Decorative Cover .
- Top & Bottom Profile.
- Side Profile.
- Handles.
- Divider Profile as Per Requirement.

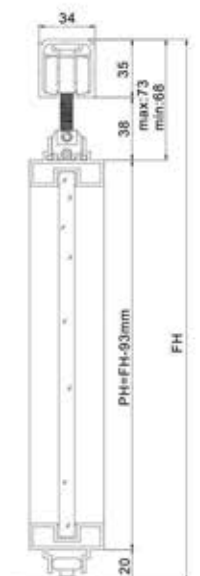
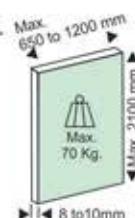

## Features

For Double Leaf Sliding Doors, Synchronized Inversion Sliding System for Double Doors.  
 Suitable for Sliding Doors for Homes, Hotels, Office Buildings etc .  
 Space Saving, Good Decorative .  
 Sliding Track: Aluminium Anodized.  
 Hanging Roller: Zinc Alloy, SN.



**TCH-8824**  
Profile Synchronized Sliding System

Synchronized Accessories Set.  
 Sliding Top Track.  
 Track Decorative Cover .  
 Top & Bottom Profile.  
 Side Profile.  
 Handles.  
 Divider Profile as Per Requirement.

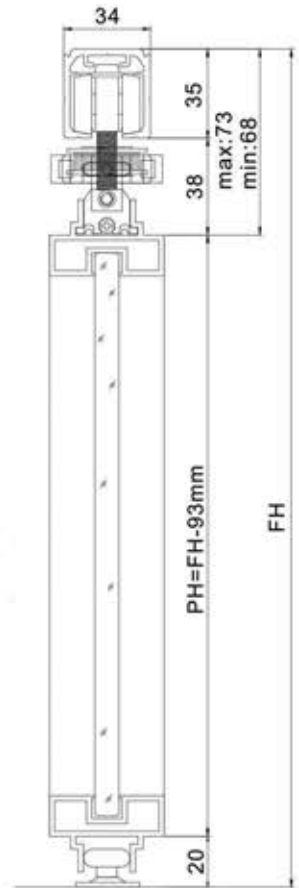

## ACCESSORIES FOR FITTINGS



Fitting Accessories



**TCH-8825**  
Sliding Handle



**TCH-8826**  
Sliding Handle with Lock



**TCH-8827**  
Fix Door Accessories

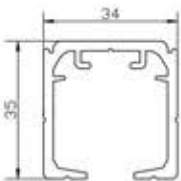

**TCH-8828**  
Sliding Top Track

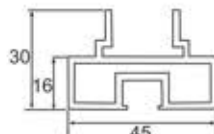

**TCH-8829**  
Top/ Bottom Profile

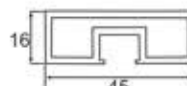

**TCH-8830**  
Side Profile



**TCH-8831**  
Decorative Profile Cover



**TCH-8832**  
Profile

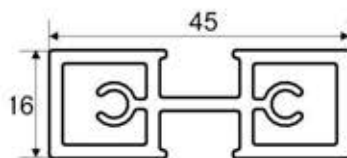

**TCH-8833**  
Divider Profile



**TCH-8834**  
Profile Corner Connector



### TCH-9000 Automatic Door Sensor

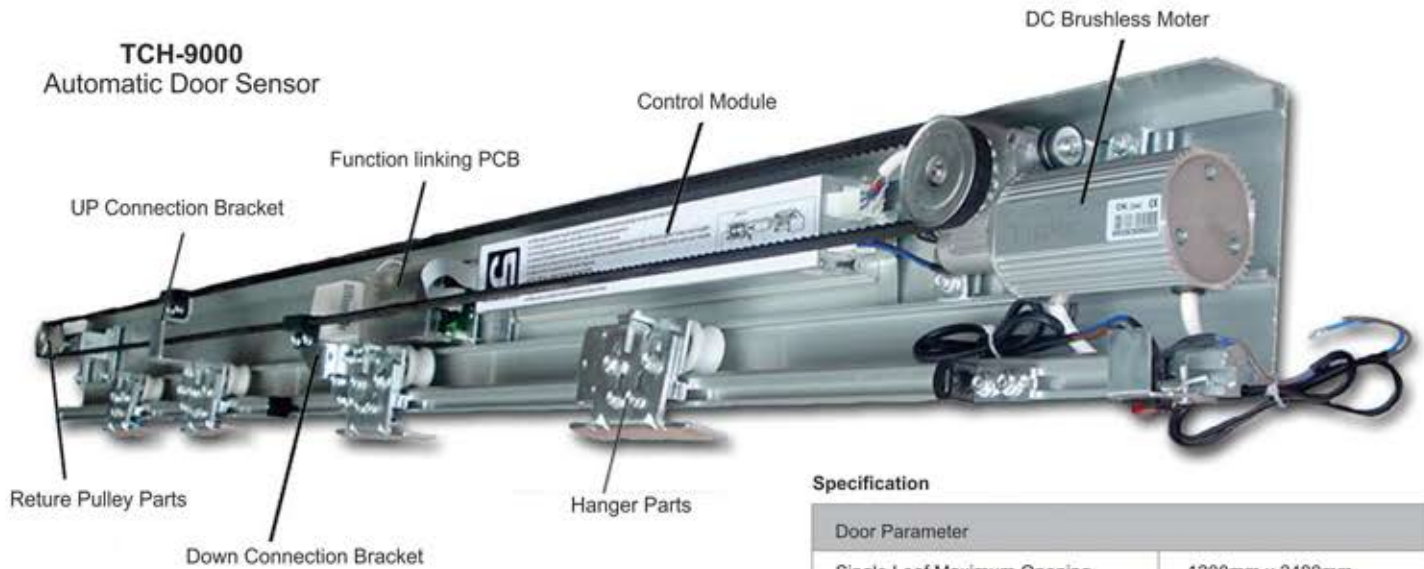

#### Features and advantages

1. Wide range of power-supply operation.
2. Intelligent control system.
3. Drive equipment with low noise
4. Advanced brushless motor and worm wheel reducer are integrated.
5. Special self-locking function without any addition components
6. With different triggered opening modes
7. Double door interlock function
8. Optional backup power supply to ensure the normal operation.
9. When door is closed, it shall be locked and kept closed
10. Apply to doors for garage, usage of anti-radiation for hospitals, warehouses, science and technology factories, barrier-free space, commercial building, shopping mall, etc.
11. To connect with safety and Security system.
12. Easy installation & Easy Maintenance.
13. Track size : 4200mm/6400mm.



#### Specification

Door Parameter	
Single Leaf Maximum Opening	1200mm x 2400mm
Bi-parting Door Maximum Opening	2200mm x 2400mm
Maximum Door Weight Single Leaf	75kg to 90kg (Single Door)
Maximum Door Weight Double Leaf	75kg x 2 Door (Bi-parting)

#### AUTOMATIC DOOR PARAMETER

TYPE	SASSD-1	
Opening Speed	Adjust Between 250-600mm/Sec.	
Closing Speed	Adjust Between 150-300mm/Sec.	
Holding Time	1-15 Sec.	
Pushing Force	<37N	<45N
Power	Ac 200-250V	
Voltage	DC 24V-50W	
Environment Temperature	-200C - +500C	



SPIDER WITHOUT FIN

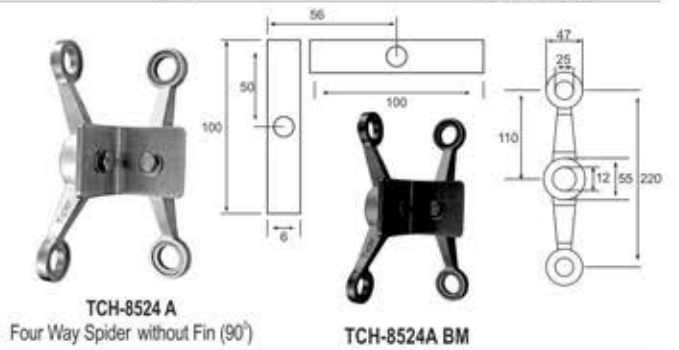
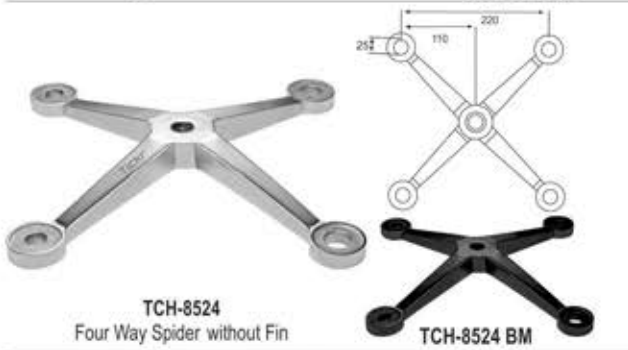

SPIDER WITH FIN

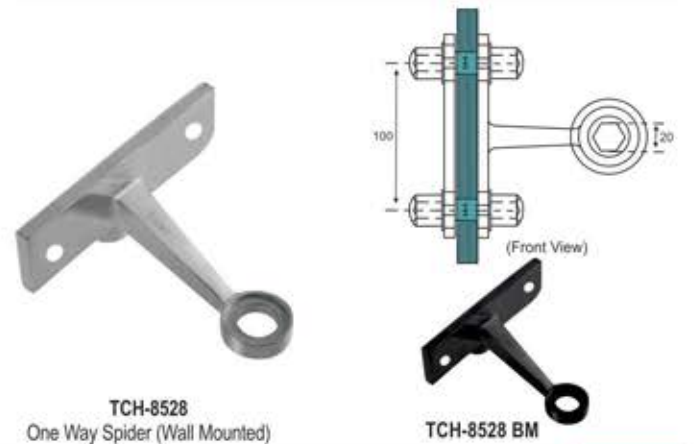
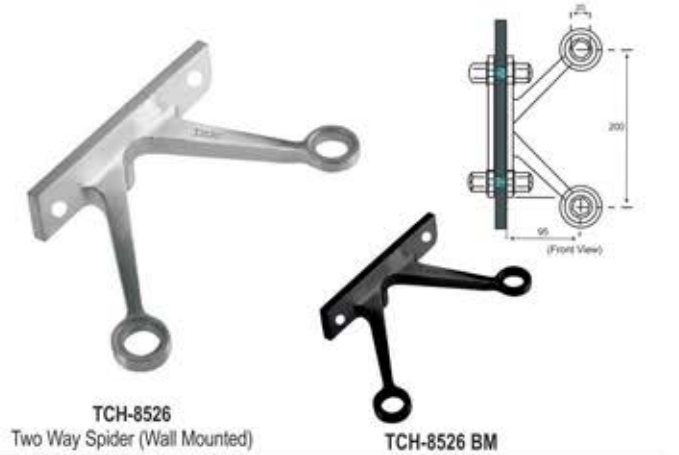

### SPIDER WITH FIN



**TCH-8835**  
One Way Spider

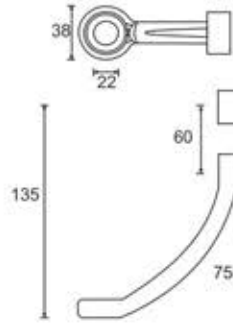

**TCH-8836**  
Two Way Spider (Wall Mounted)

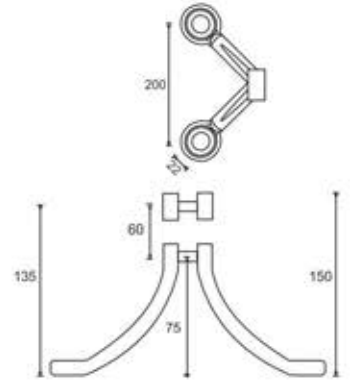

**TCH-8837**  
Two Way Spider

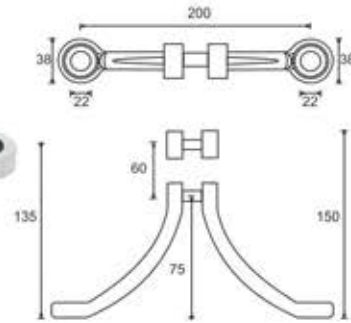

**TCH-8838**  
Four Way Spider (Wall Mounted)

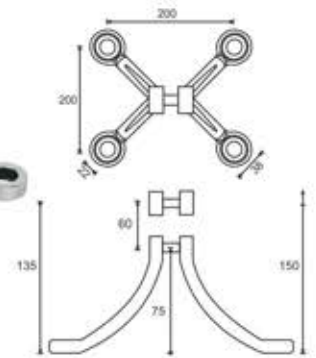

### ARTICULATED ROUTELS



**TCH-8537**  
Articulated Routel (Flat Head)

**TCH-8537 BM**



**TCH-8538**  
Articulated Routel (Cunter Sunk Hole)

**TCH-8538 BM**



**TCH-8539**  
Fixed Routel (Flat Head)

**TCH-8539 BM**

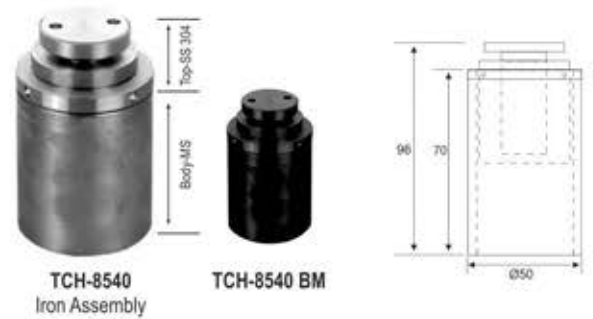

**TCH-8540**  
Iron Assembly

**TCH-8540 BM**



**TCH-8541**  
Fixed Routel (Cunter Sunk)

**TCH-8541 BM**



FIN PLATES



**TCH-8529**  
Fin Plate (200mm)

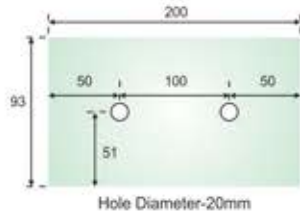

**TCH-8529 BM**



**TCH-8530**  
Fin Plate (300mm)

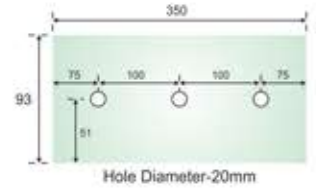

**TCH-8530 BM**



**TCH-8531**  
Fin Plate (350mm)

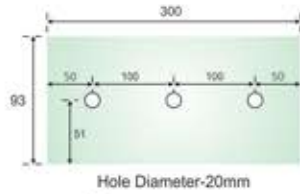

**TCH-8531 BM**



**TCH-8532**  
Fin Plate (400mm)

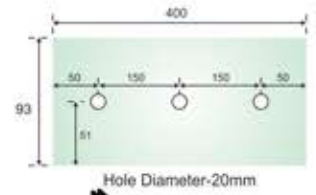

**TCH-8532 BM**

SPLICE PLATES



**TCH-8533**  
Splice Plate (200mm)

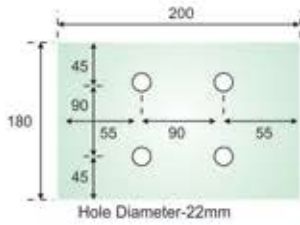

**TCH-8533 BM**



**TCH-8534**  
Splice Plate (250mm)

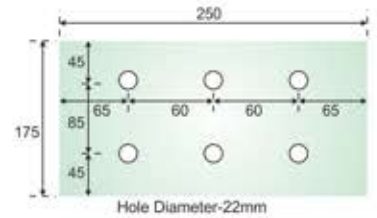

**TCH-8534 BM**



**TCH-8535**  
Splice Plate (300mm)

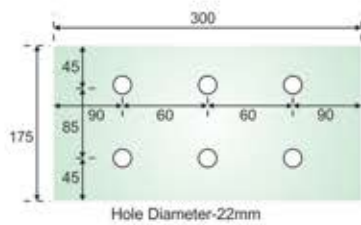

**TCH-8535 BM**



**TCH-8536**  
Splice Plate (350mm)

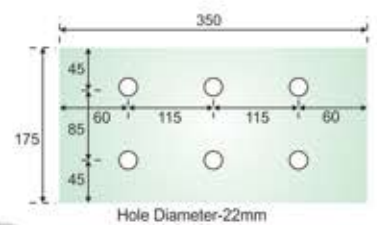

**TCH-8536 BM**

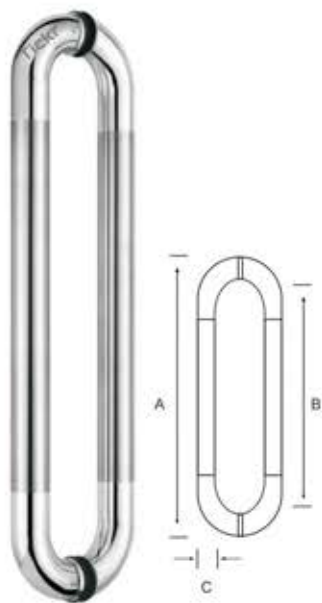

**TCH-8542**

Overall Length (A)	Centre to Centre Hole (B)	Diameter (C)
327	302	25
482	450	32



**TCH-8543**

Overall Length (A)	Centre to Centre Hole (B)	Diameter (C)
325	212	25
325	240	25
457	302	32 (SS 302)
600	455	32
900	600	32
900	700	32
1200	900	32
1500	1200	32

**TCH-8543 BM**

**TCH-8543 GD**

**TCH-8543 RG**



**TCH-8544**

Overall Length (A)	Centre to Centre Hole (B)	Diameter (C)
457	302	32

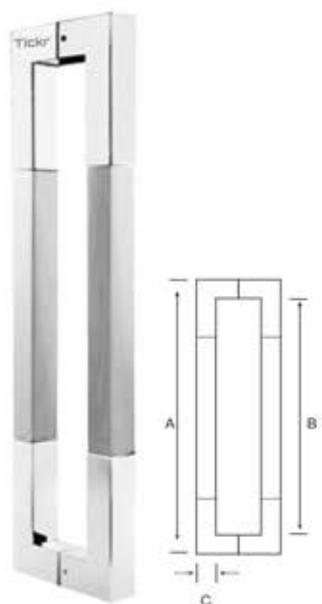

**TCH-8545**

Overall Length (A)	Centre to Centre Hole (B)	Diameter (C)
327	302	25/25
480	450	30/30

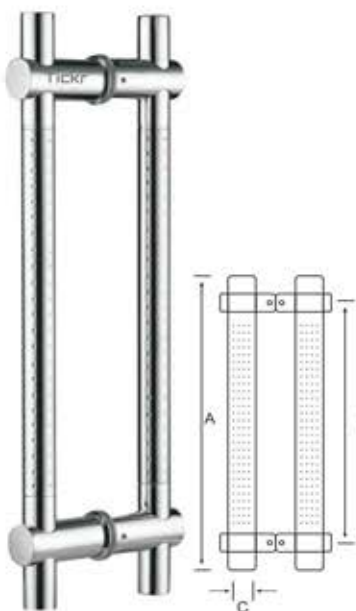

**TCH-8546 (Adjustable)**

Overall Length (A)	Centre to Centre Hole (B)	Diameter (C)
325	200	25
457	302	32



**TCH-8547**

Overall Length (A)	Centre to Centre Hole (B)	Diameter (C)
450	302	38
600	450	38



**TCH-8548**

Overall Length (A)	Centre to Centre Hole (B)	Diameter (C)
450	302	25/45



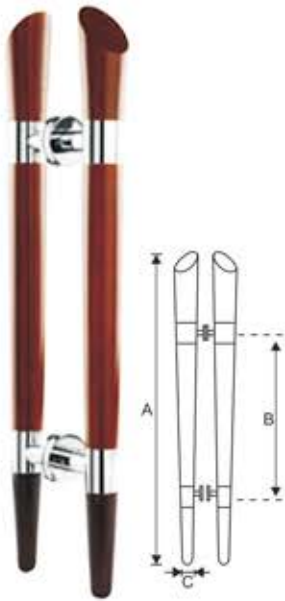

TCH-8549

Overall Length (A)	Centre to Centre Hole (B)	Diameter (C)
450	302	38



TCH-8550 (Acrylic)

Overall Length (A)	Centre to Centre Hole (B)	Diameter (C)
450	302	38



TCH-8552

Overall Length (A)	Centre to Centre Hole (B)	Diameter (C)
450	302	38/25

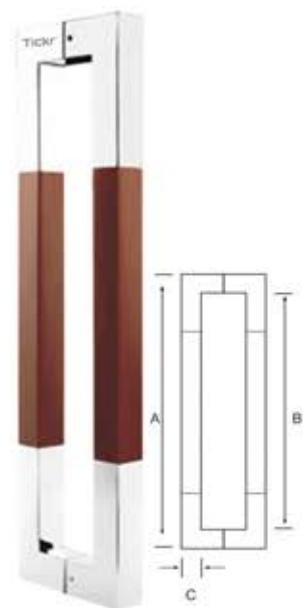

TCH-8553

Overall Length (A)	Centre to Centre Hole (B)	Diameter (C)
327	302	25/25
480	450	30/30

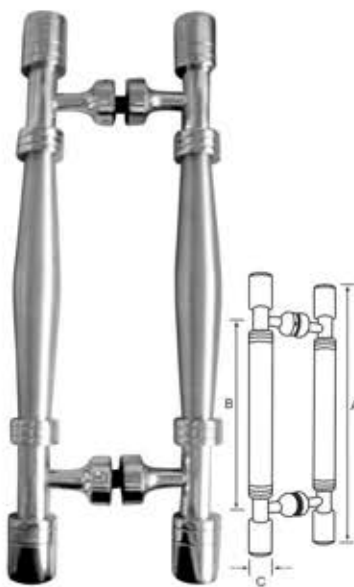

TCH-8572

Overall Length (A)	Centre to Centre Hole (B)	Diameter (C)
457	302	38

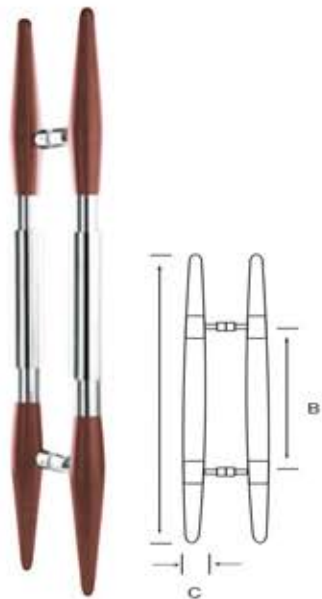

TCH-8573 (Adjustable)

Overall Length (A)	Centre to Centre Hole (B)	Diameter (C)
500	302	38
850	455	38

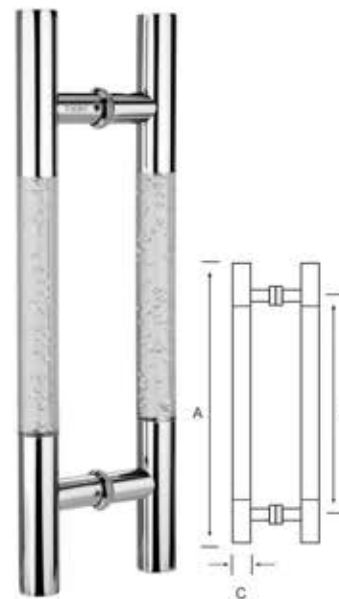

TCH-8574

Overall Length (A)	Centre to Centre Hole (B)	Diameter (C)
457	302	38
600	450	38

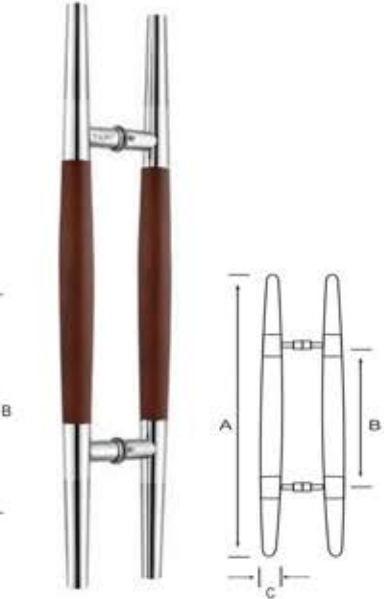

TCH-8575

Overall Length (A)	Centre to Centre Hole (B)	Diameter (C)
450	302	32

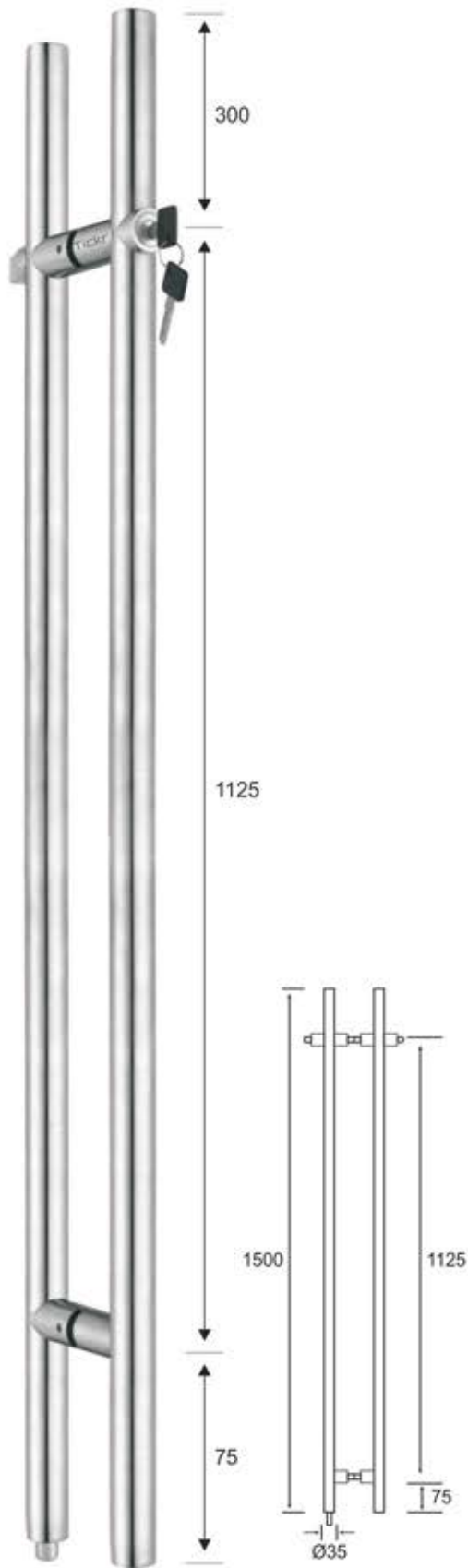

**TCH-8576**  
Size : 35X1500mm

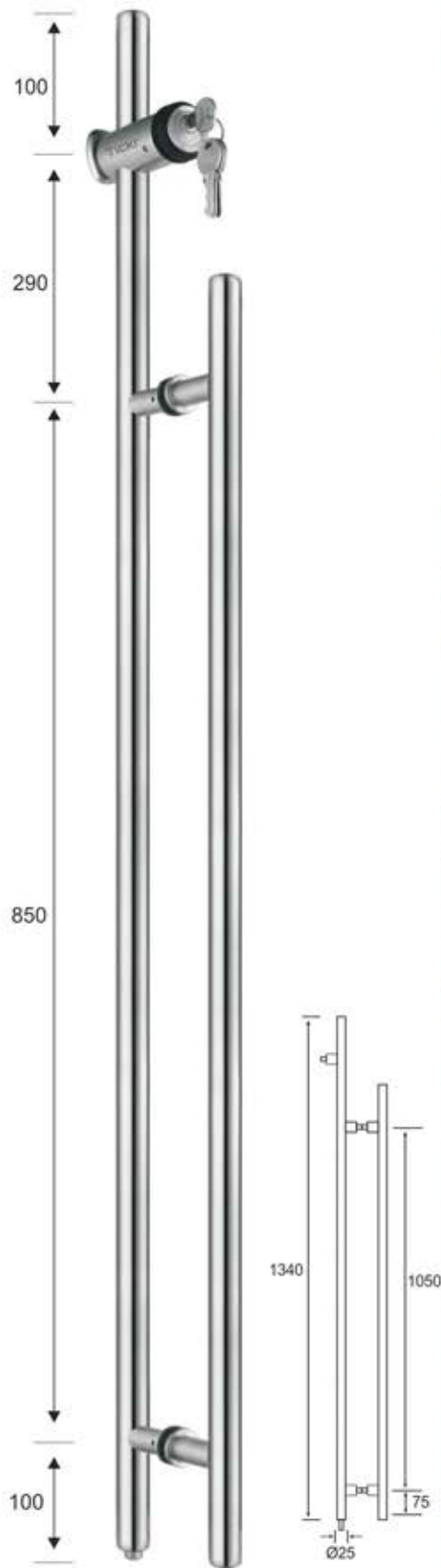

**TCH-8577**  
Size : 35X1500mm





**TCH-8578**  
Double Door Lock (Only Key)



**TCH-8579**  
Single Door Lock (Only Key)



**TCH-8556**  
Double Door Lock (Key & Knob)



**TCH-8557**  
Single Door Lock (Key & Knob)



**TCH-8558**  
Double Door Lock (Only Key)



**TCH-8559**  
Single Door Lock (Only Key)



**TCH-8560**  
Double Door Lock (Key & Knob)



**TCH-8561**  
Single Door Lock (Key & Knob)



**TCH-8562 (Slot Type)**  
Mini - Double Door Lock (Key & Knob)



**TCH-8563 (Slot Type)**  
Mini - Single Door Lock (Key & Knob)



**TCH-8564 (Pin Type)**  
Mini - Double Door Lock (Key & Knob)



**TCH-8565 (Pin Type)**  
Mini - Single Door Lock (Key & Knob)



**TCH-8566**  
Double Door Lock (Only Knob)



**TCH-8567**  
Single Door Lock (Only Knob)



**TCH-8568**  
Double Door Lock (Only Knob)



**TCH-8569**  
Single Door Lock (Only Knob)

## SLIDING GLASS DOOR LOCKS



**TCH-8570**  
Sliding Door lock (Glass to Glass)



**TCH-8571**  
Sliding Door lock (Wall to Glass)





**TCH-8580**  
Double Door lock (Glass to Glass)

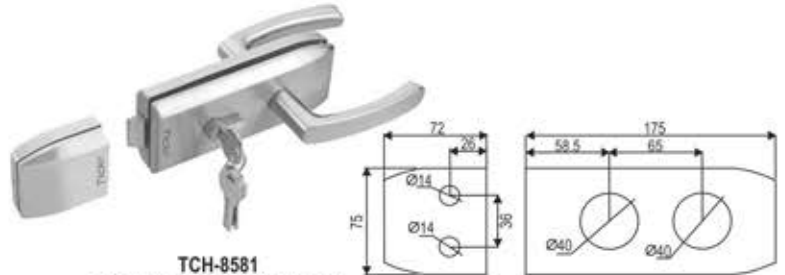

**TCH-8581**  
Single Door lock (Wall to Glass)



**TCH-8582 (Key & Knob)**  
Sliding Double Door lock  
(Glass to Glass)



**TCH-8583 (Key & Knob)**  
Sliding Single Door lock  
(Wall to Glass)



**TCH-8584 (Key & Knob)**  
Sliding Double Door lock  
(Glass to Glass)

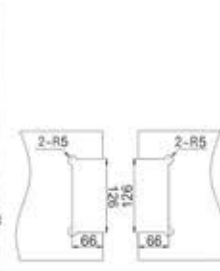

**TCH-8585 (Key & Knob)**  
Sliding Single Door lock  
(Wall to Glass)

## FINGER PRINT DOOR LOCKS



**TCH-8586**  
Electronic Double Door lock  
(Glass to Glass)



**TCH-8587**  
Electronic Single Door lock  
(Wall to Glass)



One Card Function



Finger print Indetification



Anti Theft Alarm  
(Optional)



Doorbell



Combination Lock



Low Voltage Alarm



Automatic Identify  
office Number



Undetected anti-hijacking  
Alarm Functon



Remote  
Unlock



Voice Functon



USB Data  
Acquisition



Security Against  
Peeping Password  
Input



Wireless  
Remote Control



Attendance  
Function

### Technical Details

- Fingerprint Collector : Semiconductor
- Fingerprint Capacity : 1000 Pieces
- Fingerprint Time : < 0.5 Seconds
- Resistant Rate : < 0.1%
- Leave Recognition Rate : < 0.001%
- Password Group Number : 500 Groups
- Password Length : 6-20
- IC Card group Number : 500 Groups
- Remote Control Group Number : 500 Group (Optional)
- Working Power : 4 Section 5 Basic Battery
- Operating Voltage : 4.5-6.5 V
- Operating Temperature : -20 C to 55C
- Relative Humidity : 20-93 % RH
- Main Material : Zinc Alloy Die Casting, electroplating
- Applicable Door Type : Framed Door, Glass Door without Frame
- Emergency Power Supply : Micro USB Emergency Power Supply interact, Voltage Range 5-7 V
- Emergency Power Supply : Micro USB Emergency Power Supply intedace, Voltage Range 5-7 V



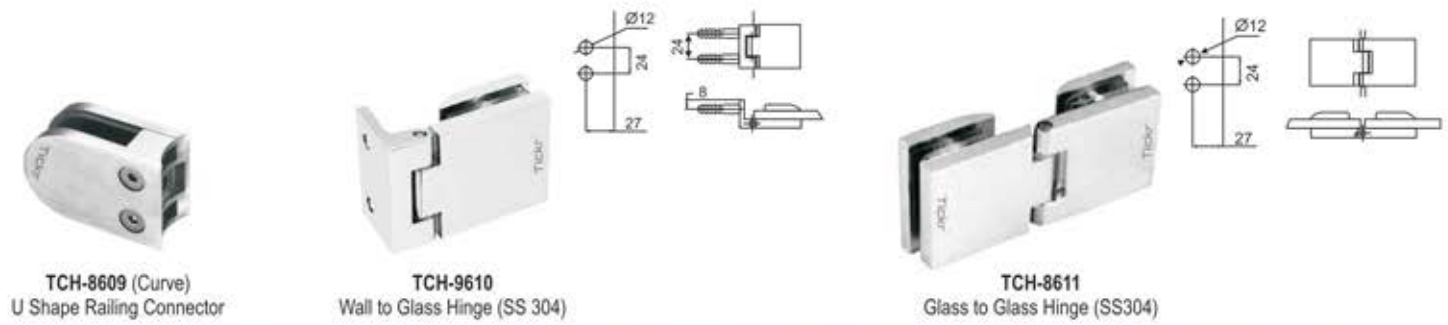



**TCH-8612**  
Single Slotted Round Pipe



**TCH-8613**  
Double Slotted Round Pipe



**TCH-8614**  
Single Slotted Curve Pipe



**TCH-8615**  
Single Slotted Square Pipe



**TCH-8616**  
Slotted Pipe Joints 180°



**TCH-8617**  
Slotted Pipe Joints 90°



**TCH-8618**  
Slotted Pipe Joints L-Type 90°



**TCH-8619**  
Straight Joints



**TCH-8620**  
Wall to Slotted Pipe Joints



**TCH-8621**  
Slotted Pipe End Caps



**TCH-8622**  
Slotted Pipe Joints 180°



**TCH-8623**  
Slotted Pipe Joints 90°



**TCH-8624**  
Slotted Pipe Joints L-Type 90°



**TCH-8625**  
Straight Joints



**TCH-8626**  
Wall to Slotted Pipe Joints



**TCH-8627**  
Slotted Pipe End Caps

### U CHANNEL

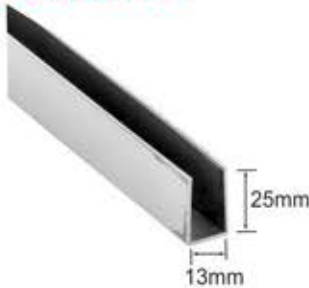

**TCH-8467 (CP)**  
U Channel (For Fixed Glass)  
Available in 3 Mtr.  
Thickness: 1.5mm  
Material : SS 304



**TCH-8467 (Black Matt)**  
U Channel (For Fixed Glass)  
Available in 3 Mtr.  
Thickness: 1.5mm  
Material : SS 304



### ALUMINIUM PROFILE



**TCH-8628**  
Glass Wedge Partition

#### Specification

- Aluminium
- Size : 3 Mtr. & 5 Mtr.
- Finish : Silver Anodized
- Glass held at every 300 mm with clamping shoes
- Do not require any glass preparation
- Low Maintenance cost
- Attached with ceiling, floor or wall
- Easy and simple installation of the glass
- Low maintenance cost
- Highly cost effective
- Fast completion of projects can be achieved
- Base section with provision to attach to fixed structure at 300mm interval





## ALUMINIUM SLIDING TRACK

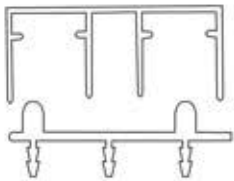

**TCH-8736**  
Aluminium Sliding Track  
**Specification**  
• Size : 8 Ft., 10 Ft., 12 Ft., 16 Ft.

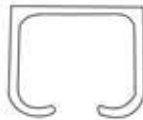

**TCH-8738**  
Aluminium Sliding Track (Light)  
**Specification**  
• Size : 8 Ft., 10 Ft., 12 Ft., 16 Ft.



**TCH-8739**  
Aluminium Sliding Track (Heavy)  
**Specification**  
• Size : 8 Ft., 10 Ft., 12 Ft., 16 Ft.

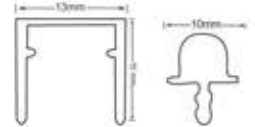

**TCH-8740**  
Aluminium Sliding Track  
**Specification**  
• Size : 10 Ft., 12 Ft.

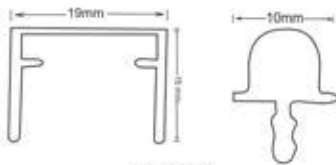

**TCH-8741**  
Aluminium Sliding Track  
**Specification**  
• Size : 10 Ft., 12 Ft.

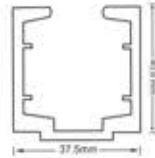

**TCH-8512**  
Aluminium Sliding Track  
**Specification**  
• Size : 8 Ft., 10 Ft., 12 Ft.

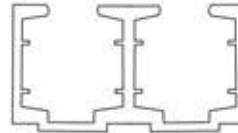

**TCH-8513**  
Aluminium Sliding Double Track  
**Specification**  
• Size : 8 Ft., 10 Ft., 12 Ft.

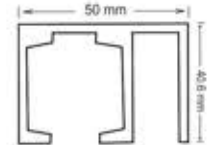

**TCH-8514**  
One Fix and One Movable Glass  
**Specification**  
• Size : 8 Ft., 10 Ft., 12 Ft.

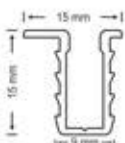

**TCH-8742**  
Sliding Fitting Track  
**Specification**  
• Size : 3 Mtr.

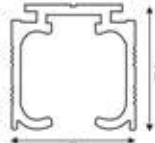

**TCH-8743**  
Aluminium Sliding Track  
**Specification**  
• Size : 8 Ft., 12 Ft.



**TCH-8744**  
Aluminium Gola Profile (G- Shape)  
**Specification**  
• Finish : Aluminium / Black  
• Size : 3mtr.



**TCH-8745**  
Aluminium Gola Profile (L- Shape )  
**Specification**  
• Finish : Aluminium / Black  
• Size : 3mtr.



**TCH-8746**  
Aluminium Sliding Track  
**Specification**  
• Finish : Aluminium  
• Size : 8ft., 12Ft.



**TCH-8701 Set**  
Slim Tandom Box

- Specification**
- Finish : Dark Grey
  - Dynamic Load Capacity : 45kg.
  - High Quality Metal with Matt Finish
  - Silent System Guarantees smooth Run without Noise
  - Size : 350 mm, 400 mm, 450 mm, 500 mm, 550 mm



**TCH-8702 Set**  
Tandom Box

- Specification**
- Finish : Dark Grey
  - Dynamic Load Capacity : 45kg.
  - High Quality Metal with Matt Finish
  - Silent System Guarantees smooth Run without Noise
  - Size : 350 mm, 400 mm, 450 mm, 500 mm, 550 mm



**TCH-8703 Set**  
Tandom Box

- Specification**
- Finish : Dark Grey
  - Dynamic Load Capacity : 45kg.
  - High Quality Metal with Matt Finish
  - Silent System Guarantees smooth Run without Noise
  - Size : 350 mm, 400 mm, 450 mm, 500 mm, 550 mm



**TCH-8704**  
Tandom Box



**TCH-8705**  
Tandom Box



**TCH-8706**  
Tandom Box





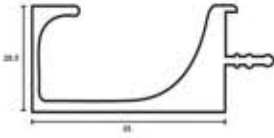

**TCH-8707**

Aluminium G Profile (35 mm)

**Specification**

- Finish : Aluminium/ Brushed SS/ Brushed CP
- Glass Thickness : 4 mm / 5 mm
- Size : 3 Mtr.

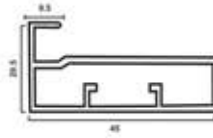

**TCH-8708**

Aluminium Frame Profile (45 mm)

**Specification**

- Finish : Aluminium/ Brushed SS/ Brushed CP
- Glossy CP/ Black/ Rose Gold
- Glass Thickness : 4 mm / 5 mm
- Size : 3 Mtr.

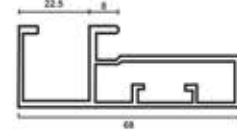

**TCH-8709**

Aluminium Handle Profile (68 mm)

**Specification**

- Finish : Aluminium/ Brushed SS/ Brushed CP
- Glossy CP/ Black/ Rose Gold
- Glass Thickness : 4 mm / 5 mm
- Size : 3 Mtr.

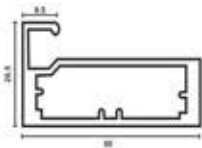

**TCH-8710**

Aluminium Shutter Profile (50 mm)

**Specification**

- Finish : Aluminium/ Brushed SS/ Brushed CP / Black
- Glass Thickness : 6 mm
- Size : 3 Mtr.

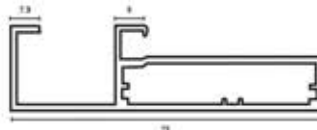

**TCH-8711**

Aluminium Handle Profile (75 mm)

**Specification**

- Finish : Aluminium/ Brushed SS/ Brushed CP / Black
- Glass Thickness : 6 mm
- Size : 3 Mtr.

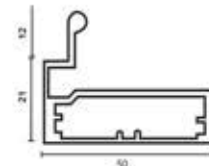

**TCH-8712**

Aluminium Handle Profile (50 mm)

**Specification**

- Finish : Aluminium/ Brushed SS/ Brushed CP / Black
- Glass Thickness : 6 mm
- Size : 3 Mtr.

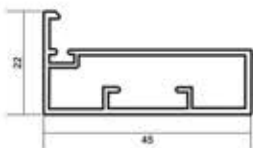

**TCH-8713**

Aluminium Shutter Profile (45 mm)

**Specification**

- Finish : Aluminium/ Brushed SS/ Brushed CP / Black
- Glass Thickness : 4 mm / 5 mm
- Size : 3 Mtr.

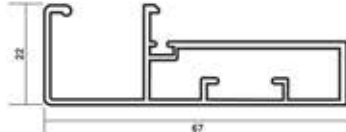

**TTCH-8714**

Aluminium Handle Profile (67 mm)

**Specification**

- Finish : Aluminium/ Brushed SS/ Brushed CP / Black
- Glass Thickness : 4 mm / 5 mm
- Size : 3 Mtr.

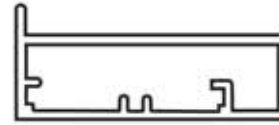

**TCH-8715**

Aluminium Shutter Profile (50 mm)

**Specification**

- Finish : Aluminium/ Brushed SS/ Brushed CP / Black
- Glass Thickness : 4 mm / 5 mm
- Size : 3 Mtr.

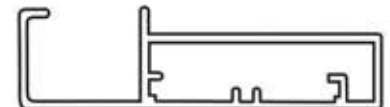

**TCH-8716**

Aluminium Handle Profile (75 mm)

**Specification**

- Finish : Aluminium/ Brushed SS/ Brushed CP / Black
- Glass Thickness : 4 mm / 5 mm
- Size : 3 Mtr.

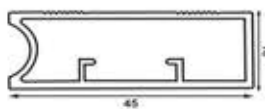

**TCH-8717**

Aluminium Frame Profile (45 mm)

**Specification**

- Finish : Aluminium/ Brushed SS / Black
- Size : 3 Mtr.

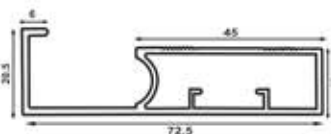

**TCH-8718**

Aluminium Handle Profile (72 mm)

**Specification**

- Finish : Aluminium/ Brushed SS / Black
- Size : 3 Mtr.

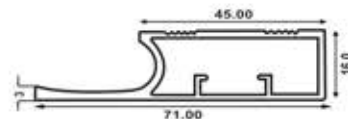

**TCH-8719**

Aluminium Handle Profile (68 mm)

**Specification**

- Finish : Aluminium/ Brushed SS/ Brushed CP / Black
- Size : 3 Mtr.

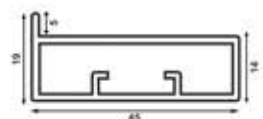

**TCH-8720**

Aluminium Frame Profile (45 mm)

**Specification**

- Finish : Aluminium/ Brushed SS/ Brushed CP / Black
- Size : 3 Mtr.

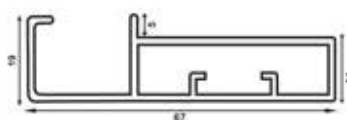

**TCH-8721**

Aluminium Handle Profile (67 mm)

**Specification**

- Finish : Aluminium/ Brushed SS/ Brushed CP / Black
- Size : 3 Mtr.

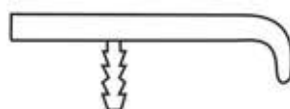

**TCH-8722**

Aluminium 'J' Handle Profile (40 mm)

**Specification**

- Finish : Aluminium/ Brushed SS/ Brushed CP / Black
- Size : 3 Mtr.

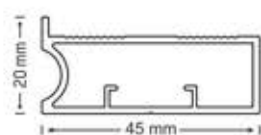

**TCH-8723**

Aluminium Frame Profile (45 mm)

**Specification**

- Finish : Aluminium / Black / Rose Gold / Grey
- Size : 3 Mtr.

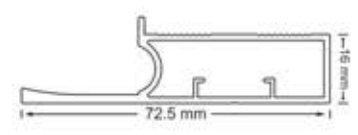

**TCH-8724**

Aluminium Handle Profile (72.5 mm)

**Specification**

- Finish : Aluminium / Black / Rose Gold / Grey
- Size : 3 Mtr.

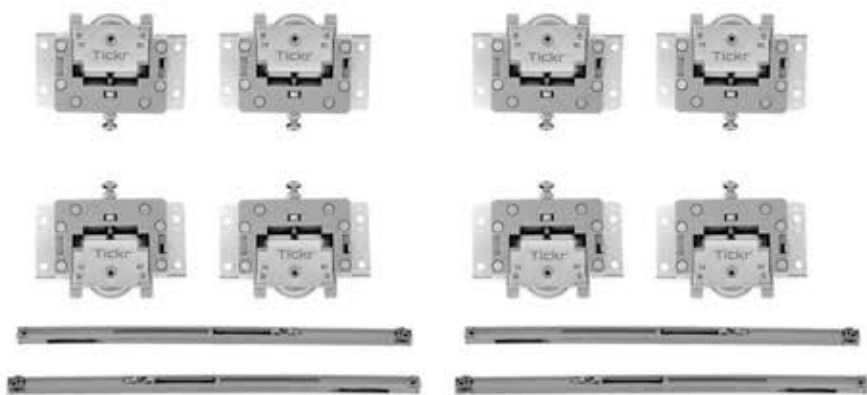

**TCH-8725**  
Wardrobe Soft Close Sliding System



**TCH-8726**  
Aluminum Sliding Track for  
TCH-0000

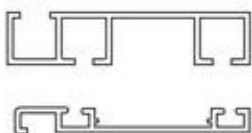

**Specification**  
• Finish : Aluminium  
• Size : 8ft., 12Ft.



## AUTO CLOSING HINGES

Clip on Hinges M. S. Soft Close Thick Door



**TCH-8727**  
Full Overlay Hinges 0°



**TCH-8728**  
Half Overlay Hinges 8°



**TCH-8729**  
Inset Lay Hinges 16°

### M. S. 3 D Soft Close Hinges



**KTCH-8730**  
Soft Close Hinges 0°



**TCH-8731**  
Soft Close Hinges 8°



**TCH-8732**  
Soft Close Hinges 16°



**TCH-8733**  
Telescopic Channel (Premium)

**Specification**  
• Material : SSS  
• Sizes : 10" to 24"



**TCH-8733 BM**  
Telescopic Channel (Premium)

**Specification**  
• Material : SSS  
• Sizes : 10" to 24"



**TCH-8734**  
Telescopic Channel Heavy Duty (53 mm)

**Specification**  
• Weight Capacity : upto 90 Kg.  
• Sizes : 14" to 48"



**TCH-8734 BM**  
Telescopic Channel Heavy Duty (53 mm)

**Specification**  
• Weight Capacity : upto 90 Kg.  
• Sizes : 14" to 48"



**TCH-8735**  
Telescopic Channel (Premium)

**Specification**  
• Material : Iron  
• Finish : Zinc  
• Sizes : 10" to 24"



**TCH-8735 BM**  
Telescopic Channel (Premium)

**Specification**  
• Material : Iron  
• Finish : Black Powder Coated  
• Sizes : 10" to 24"





**Tickr**<sup>®</sup>  
MAKE YOUR HOME HAPPY

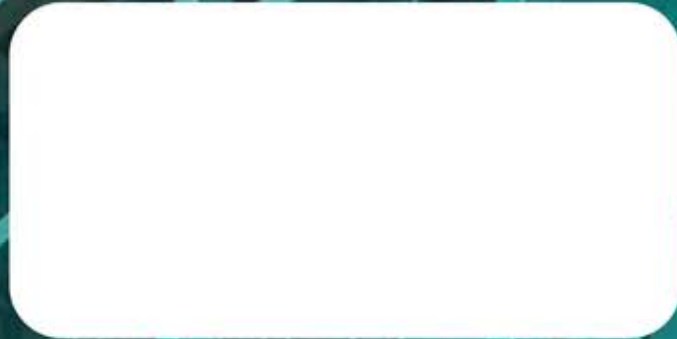

Product photos shown in catalogue are only the visual and may be differ from original.  
The technical presentation and dimension in illustrations and drawings shown are for reference only.  
Pls. refer the original product for toughen glass cutout.