

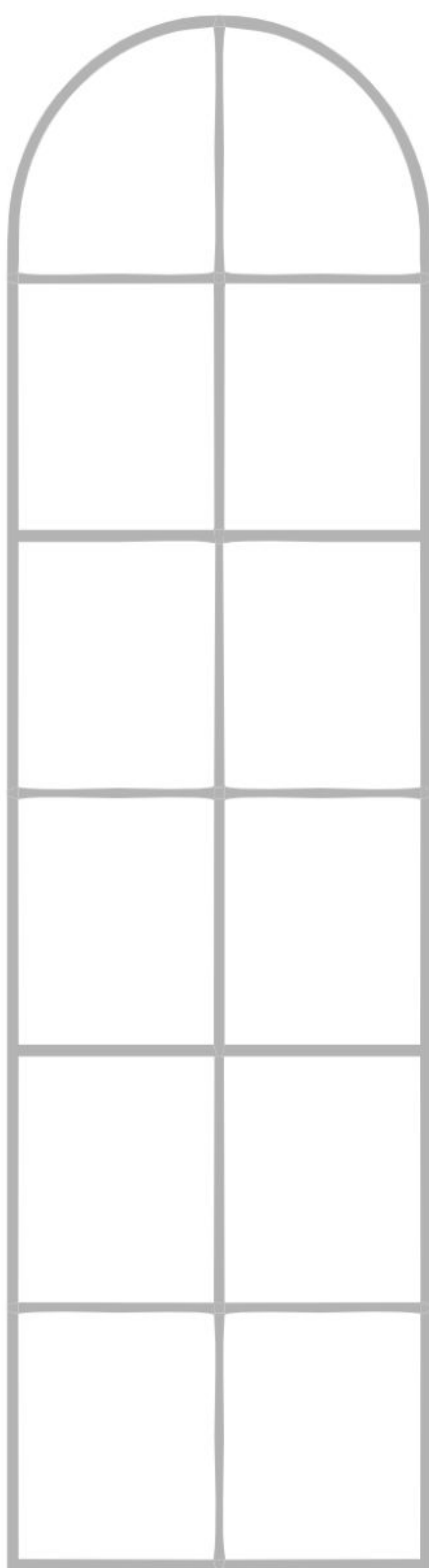

Windows | Partition |
Railing | Fins & Louvers



WHERE VISION
MEETS INNOVATION

ABOUT US

We at H LINE offer the best quality
System Windows & doors, Façade, Partition, Railing & Louvers.

With 1,00,000 sq.ft. Manufacturing Facility & In-House Powder Coating Based
at Surat, Gujarat, we are equipped with the industry's most advanced
technology with high capacity machining equipment.

Since 2007 We have manufactured numerous types of façade,
windows, doors systems and therefore, we understand what quality
needs to be performed & look like onsite. H LINE possesses 15+ years
of outstanding consistency, durability, and quality.

H-LINE has an adaptable system with exceptionally slim sections,
excellent performance and a high quality finish. Every individual
window or door is a customized product, tailored to your precise
specification and needs, every part of the range delivers on the
H-LINE Promise.

We provide the best consultancy in the selection, design, structure as
well as type of opening of windows and doors systems. We are popular
with strong commitment, best quality product and prompt after sales
service in the market of Aluminum System Windows and Façade.



OUR VISION



- ✦ Our Vision is to continuously strive for excellence by enhancing quality, crafting exceptional designs, & building strong, lasting relationships with our clients.
- ✦ Every client and team member is valued & integral to our success. We prioritize business ethics & teamwork, ensuring they remain at the core of everything we do.
- ✦ Sustainability is a key focus in our processes & management. We take responsibility for our social, economic, and environmental impact, committing to a better future for all.
- ✦ Excellence is not a destination; it's a journey we take together—crafting quality, fostering relationships, & shaping a sustainable future with integrity at our core.



At H-LINE, our ISO 9001:2015 certification reflects our dedication to maintaining the highest standards in product quality, manufacturing processes, and customer service. We follow globally recognized quality management principles to ensure innovation, reliability, and excellence in every solution we deliver from windows and doors to façades, fins, and louvers

OUR MISSION

We aim to be a world-class provider of innovative windows & doors, façades, partitions, and railings, delivering top-notch quality, exceptional designs, and a refined aesthetic.

H-Line products redefine everyday living with unmatched quality and innovation—essential for every modern home!



WHY CHOOSE H-LINE?

Innovative, Secure, & Stylish Window & Door Solutions.

Customized Design Solutions

We specialize in crafting windows and doors tailored to your needs, ensuring the perfect fit for your space.

Cost-Efficient & Value-Enhancing

Our products are designed to be affordable while significantly increasing your property's value.

Guaranteed Durability

Built to last, our windows and doors come with a written warranty, giving you complete peace of mind.

Premium Hardware & Accessories

Engineered for optimal performance, our hardware is rigorously tested for strength and longevity.

Enhanced Security

High-quality materials and advanced locking systems provide superior protection for your home or business.

Minimal Sightlines, Maximum Aesthetics

Our sleek aluminum systems feature ultra-slim profiles for a modern and elegant look.

Effortless Operation

Designed for smooth and hassle-free use, eliminating unnecessary noise and ensuring a peaceful environment.

Superior Sound Insulation

Our specialized glass configurations effectively reduce noise, creating a quieter indoor space.



WINDOW
SOLUTIONS

OUR PRODUCT R A N G E

Discover the Perfect Blend of Innovation & Design with H LINE – A Comprehensive Range of Premium Windows, Doors, Partitions, and More!



Windows frame

the world



our path

doors shape

ADVANTAGES OF ALUMINUM WINDOWS

Stay Comfortable with Thermal & Sound Insulation

Enjoy a cozy home all year round. Our windows and doors provide excellent insulation, keeping the heat out in summer and the cold away in winter. Plus, with acoustical glass, say goodbye to outside noise and hello to peace and quiet.

Designed to Match Your Style

No matter your taste—sleek and modern or rustic and classic—we've got a design that fits perfectly. With a variety of shapes, styles, and finishes, you're sure to find the perfect match for your home.

Built for Safety & Fire Protection

Your safety comes first. Our windows and doors are made from strong, non-flammable materials that integrate with the latest safety technologies, offering you peace of mind.

Hassle-Free Maintenance

Forget about repainting or tedious upkeep. Our low-maintenance windows and doors only need an occasional wipe-down with soapy water to stay looking brand new.

Expert Installation for a Perfect Fit

A great product deserves a flawless installation. Our skilled professionals ensure everything is fitted precisely, so you enjoy smooth operation and long-lasting performance. Upgrade your home with windows and doors that offer beauty, comfort, and security—all in one.



HL IMPERIAL
SLIM SYSTEM



HL IMPERIAL SLIM SYSTEM

The Zenith of Design: Imperial Slim Sliding Windows with Invisible Frames

Step into a realm of unparalleled luxury and architectural marvel with HL Imperial Slim Sliding Windows. Conceived for the most discerning connoisseurs of design and the most opulent properties, this system redefines the very essence of panoramic living. Our Imperial windows feature a revolutionary **invisible frame design**, where the robust, precision-engineered structure is seamlessly concealed within your building's architecture. The result is an **uninterrupted expanse of pure glass**, offering boundless views that invite the outside in without a single visual obstruction. Crafted from the most **exclusive, premium-grade materials** and perfected with meticulous attention to detail, every Imperial window delivers **effortless, silent operation** and unyielding security, making it the ultimate statement in **extreme luxury** and sophisticated minimalism for your most prestigious spaces.



Sound insulation



Water tightness



Wind load



Color choice



Impact resistance



10 years warranty

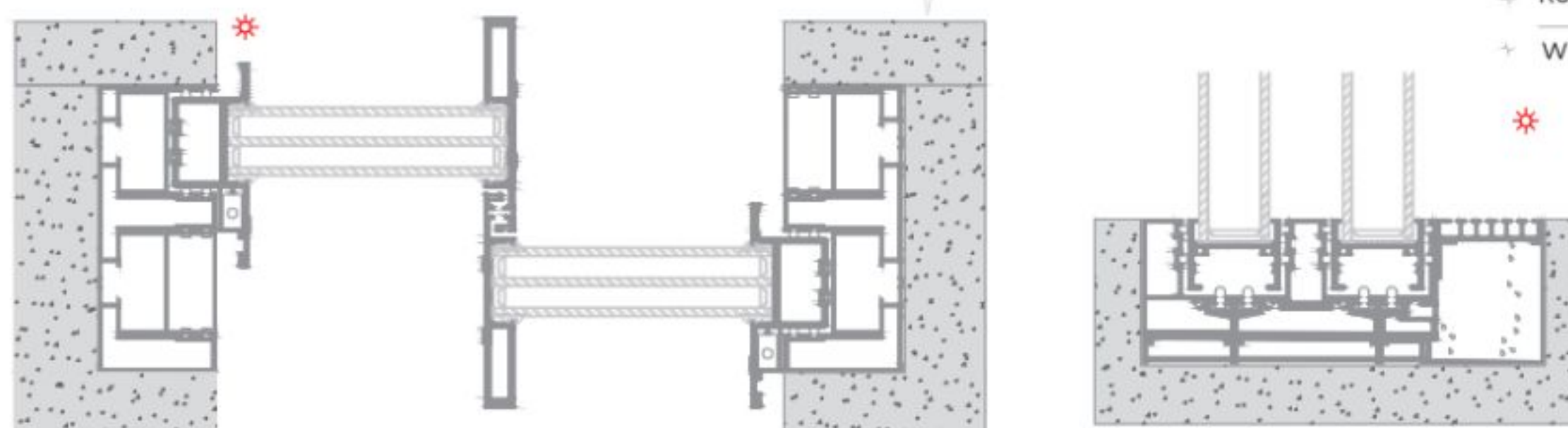

TECHNICAL SPECIFICATION

- ✦ Track Frame Width : 164 MM
- ✦ Track Frame Height : 68 MM
- ✦ Interlock Sightline : 17 MM
- ✦ Glass Thickness : 20 MM To 38 MM
- ✦ Max. Shutter Height : 6000 MM
- ✦ Max. Shutter Width : 3500 MM
- ✦ Locking Type : Multi Locking (Top-Bottom)
- ✦ Mosquito Net : Integrated Pleated
- ✦ Roller Capacity : Up to 500 kg
- ✦ Wind Load Capacity : 3.8 KPA

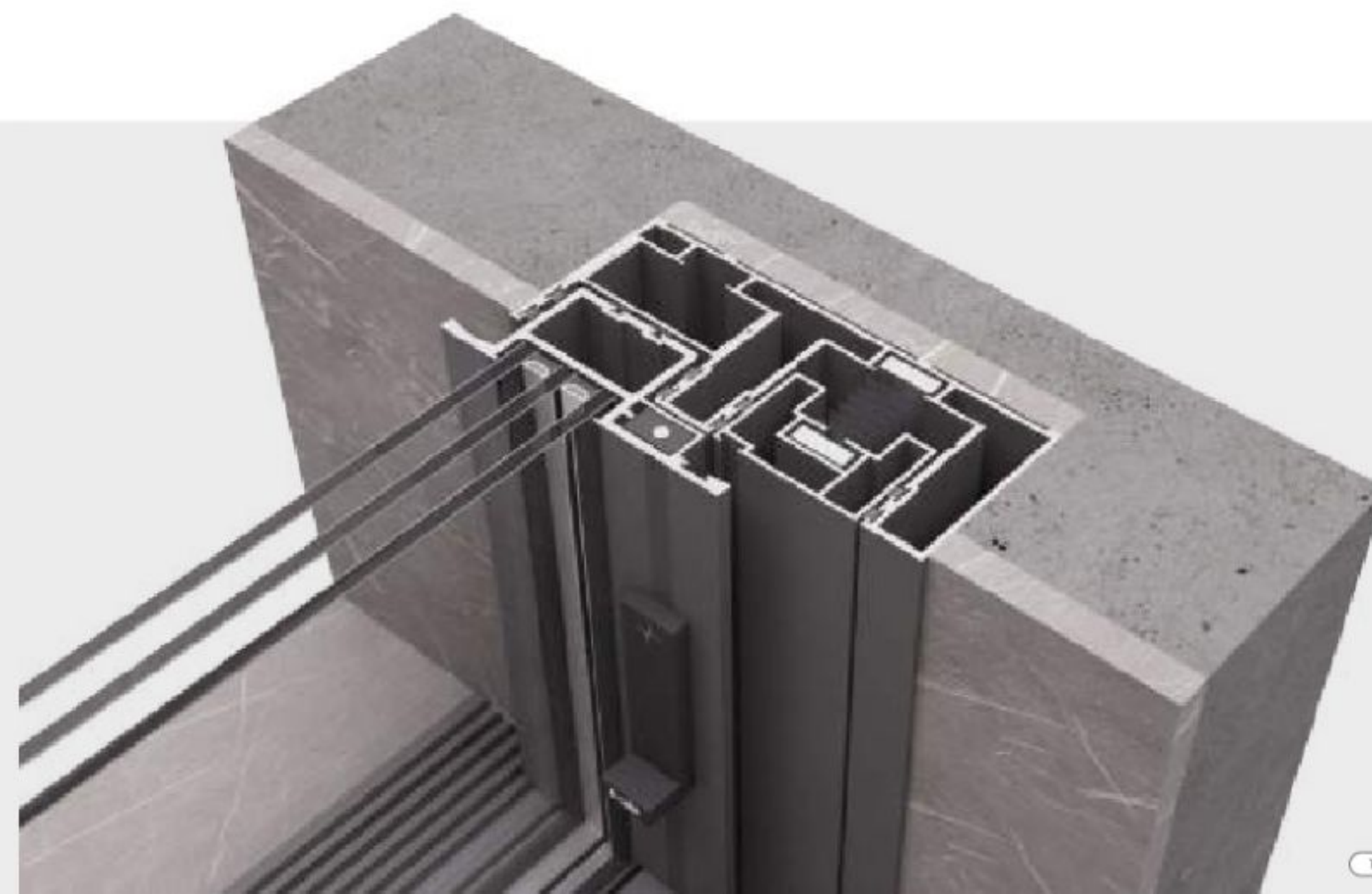
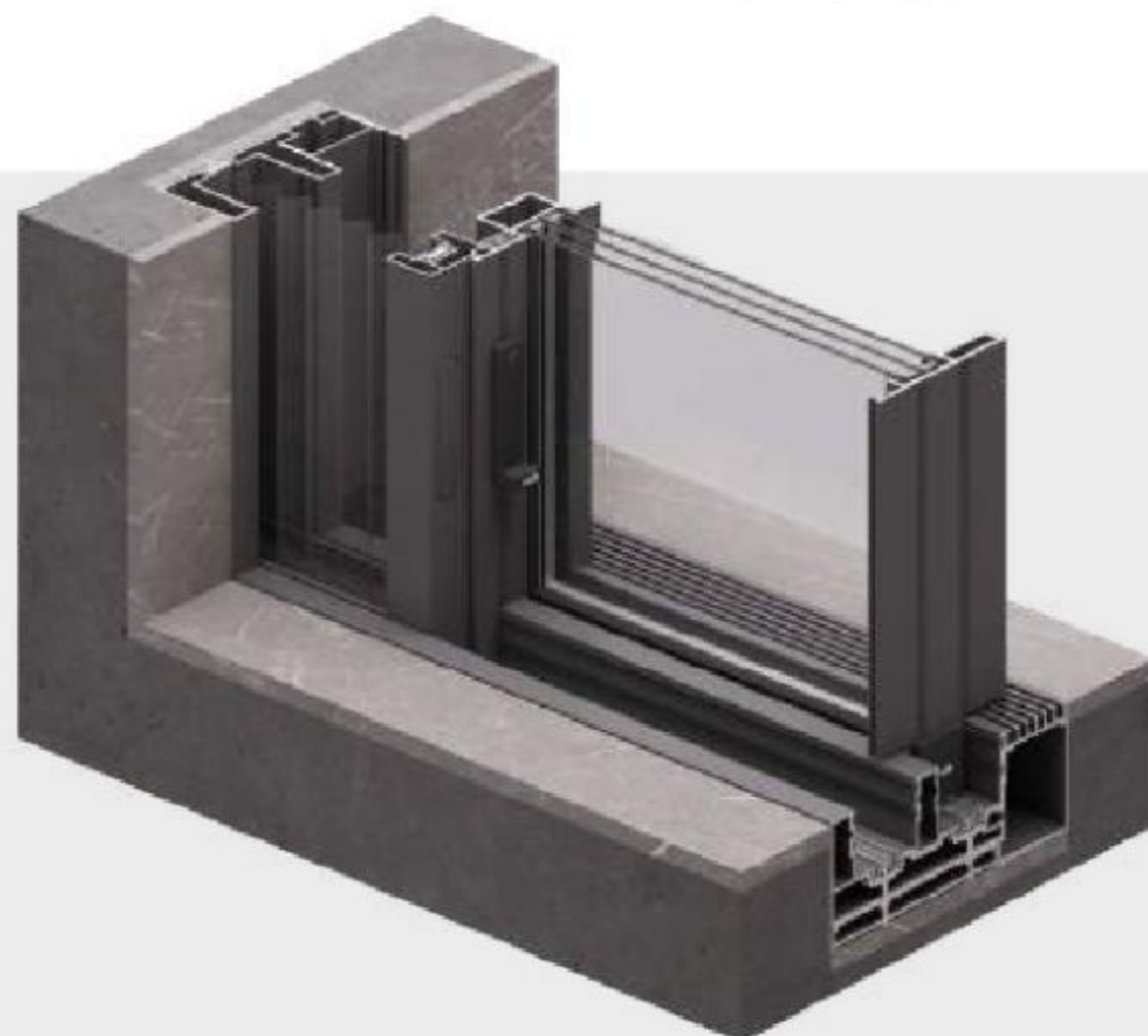

HL IMPERIAL SLIM SYSTEM-SS2

The All-Way Concealed Frame Option for HL Imperial Slim System is the ultimate expression of minimalist design, with the entire frame and track hidden within the surrounding walls. This system creates a stunning, frameless opening, giving the illusion of a clear, uninterrupted glass panel that slides effortlessly into a pocket. It's the perfect choice for high-end architectural projects where the goal is to achieve an unparalleled sense of openness and sleek sophistication.

Technical Specification For OP2

- ✦ Track Frame Width : 225 MM
- ✦ Track Frame Height : 105 MM
- ✦ Interlock Sightline : 17 MM
- ✦ Glass Thickness : 20 MM To 38 MM
- ✦ Max. Shutter Height : 6000 MM
- ✦ Max. Shutter Width : 3500 MM
- ✦ Locking Type : Multi Locking (Top-Bottom)
- ✦ Mosquito Net : NO
- ✦ Roller Capacity : Up to 500 kg

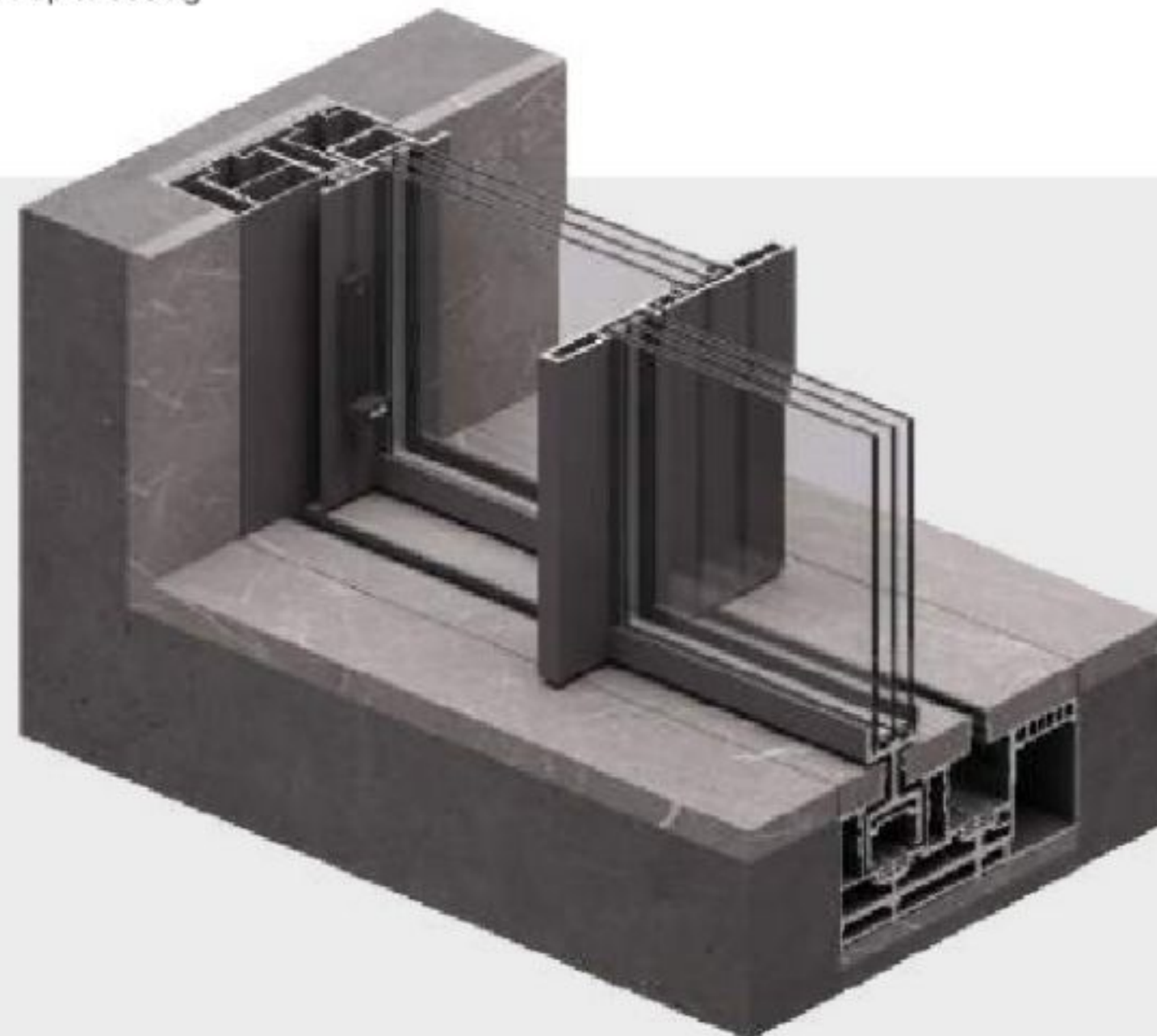
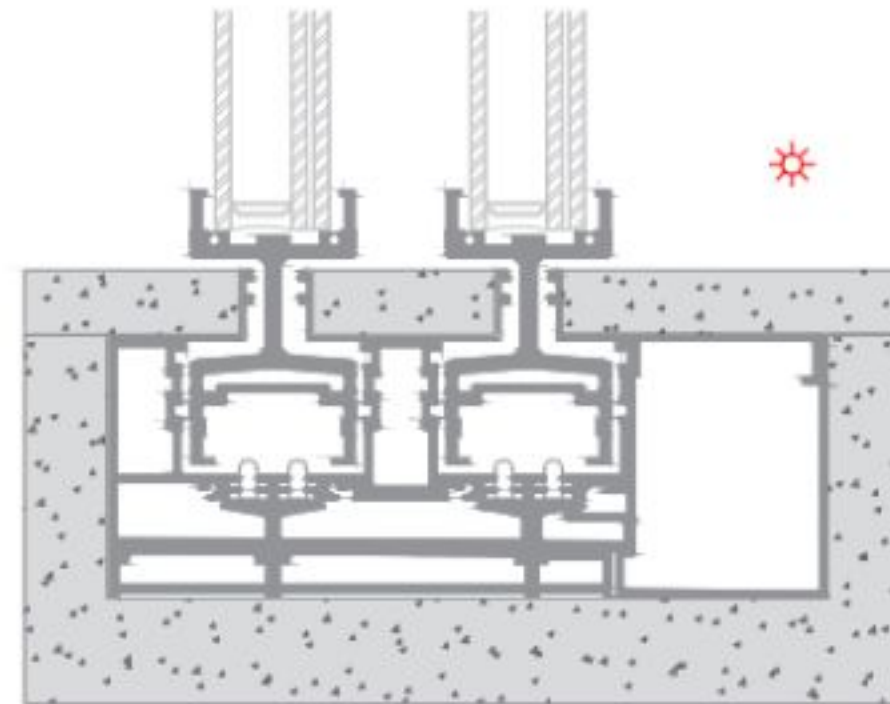

HL IMPERIAL SLIM SYSTEM-SS3

The One-Side Concealed Aluminium Sliding Door System offers a seamless, minimalist aesthetic by hiding the frame and tracks on one side. This innovative design creates the illusion of a floating panel, maximizing light and space for a clean, modern look.

Technical Specification For OP3

- ✦ Track Frame Width : 164 MM
- ✦ Track Frame Height : 68 MM
- ✦ Interlock Sightline : 17 MM
- ✦ Glass Thickness : 20 MM To 38 MM
- ✦ Max. Shutter Height : 6000 MM
- ✦ Max. Shutter Width : 3500 MM
- ✦ Locking Type : Multi Locking (Top-Bottom)
- ✦ Mosquito Net : NO
- ✦ Roller Capacity : Up to 500 kg

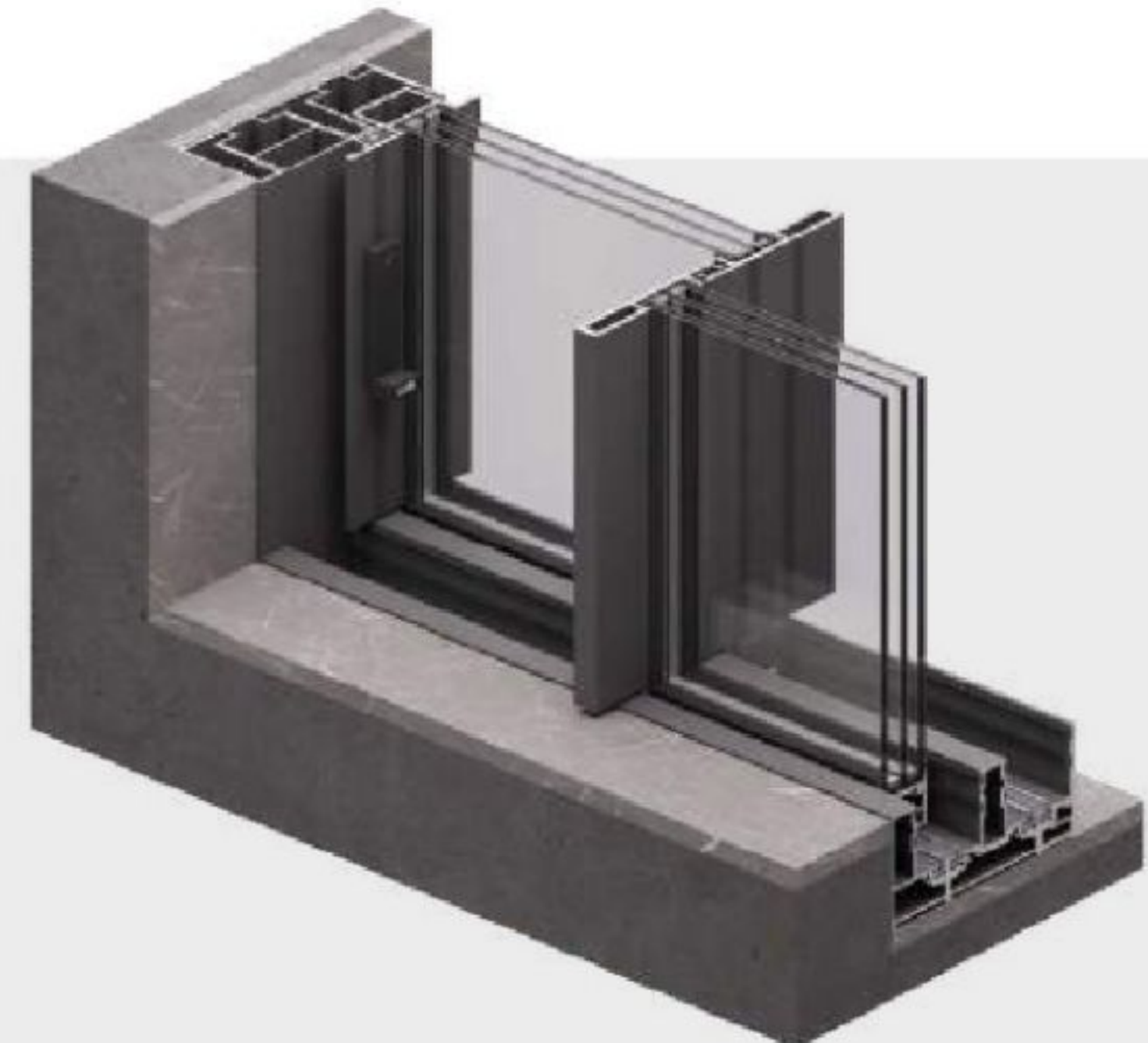
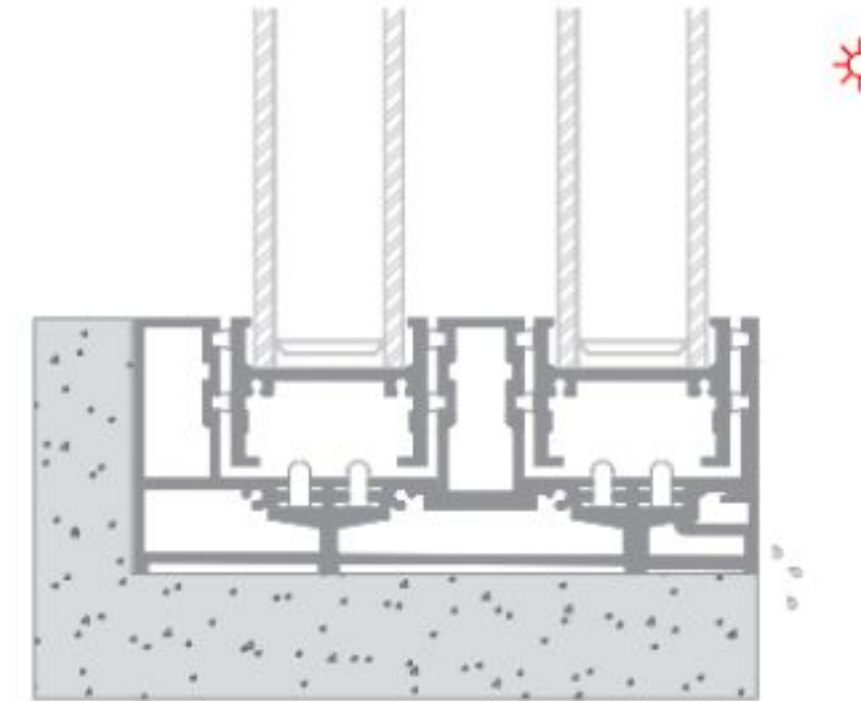

HL VISTA

SLIM SYSTEM



HL VISTA SLIM SYSTEM

HL Vista Slim: Where Architectural Vision Meets Uncompromising Luxury

Introducing the HL Vista Slim Sliding System from H-line, a truly bespoke solution crafted for those who demand nothing less than perfection. This extra-premium range is engineered for an elite clientele discerning projects worldwide, offering an unparalleled canvas of light and view. Our commitment to slimmest sightlines means the robust, precision-engineered frame virtually disappears, leaving an expansive, crystal-clear expanse that blurs the lines between indoor comfort and the grandeur of the outdoors. Beyond its aesthetic look, the Vista Slim boasts flawless, silent operation and exceptional durability, constructed from the finest materials to ensure lasting elegance and security. Choose the Vista Slim Sliding Window to transform your space into an extraordinary sanctuary of light, openness, and sophisticated living.



Sound insulation



Water tightness



Wind load



Color choice



Impact resistance



10 years warranty

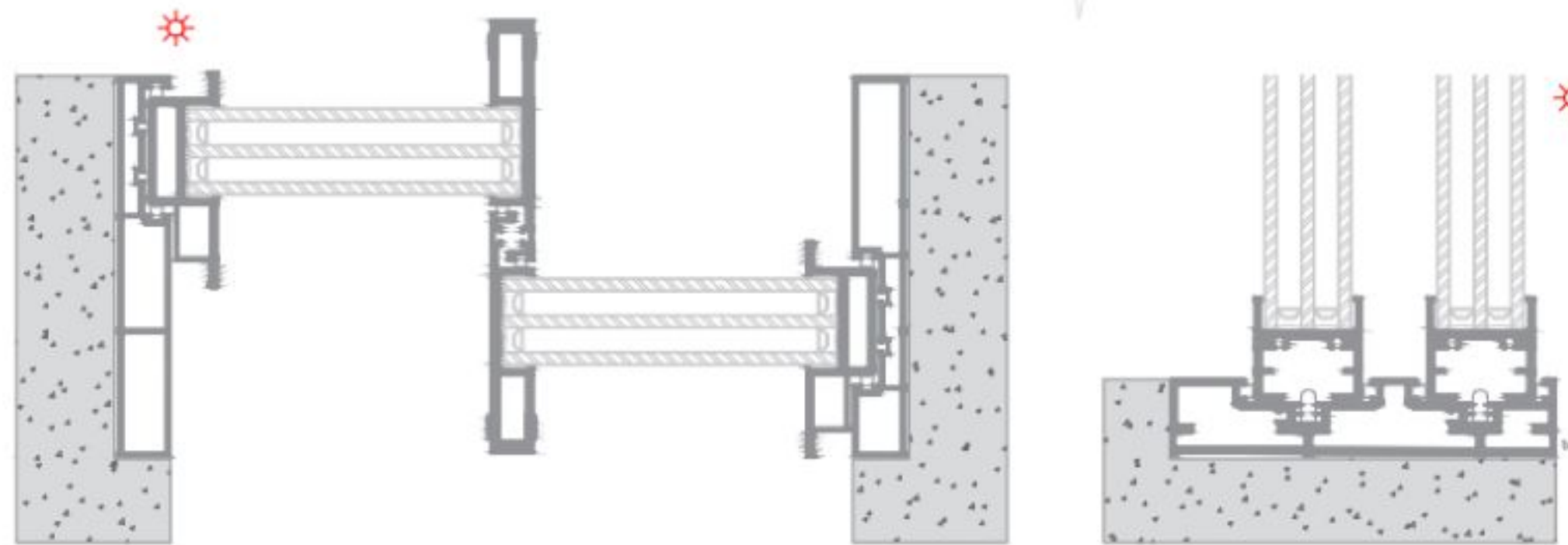

TECHNICAL SPECIFICATION

- ✦ 2 Track Frame Width : 150 MM
- ✦ 3 Track Frame Width : 217 MM
- ✦ Track Frame Height : 31MM
- ✦ Interlock Sightline : 17 MM
- ✦ Glass Thickness : 12MM TO 32 MM
- ✦ Max. Shutter Height : 4500 MM
- ✦ Max. Shutter Width : 3000 MM
- ✦ Locking Type : Multi Locking (Top-Bottom)
- ✦ Mosquito Net : Pleated
- ✦ Roller Capacity : Up to 300 Kg
- ✦ Wind Load Capacity : 2.8 KPA

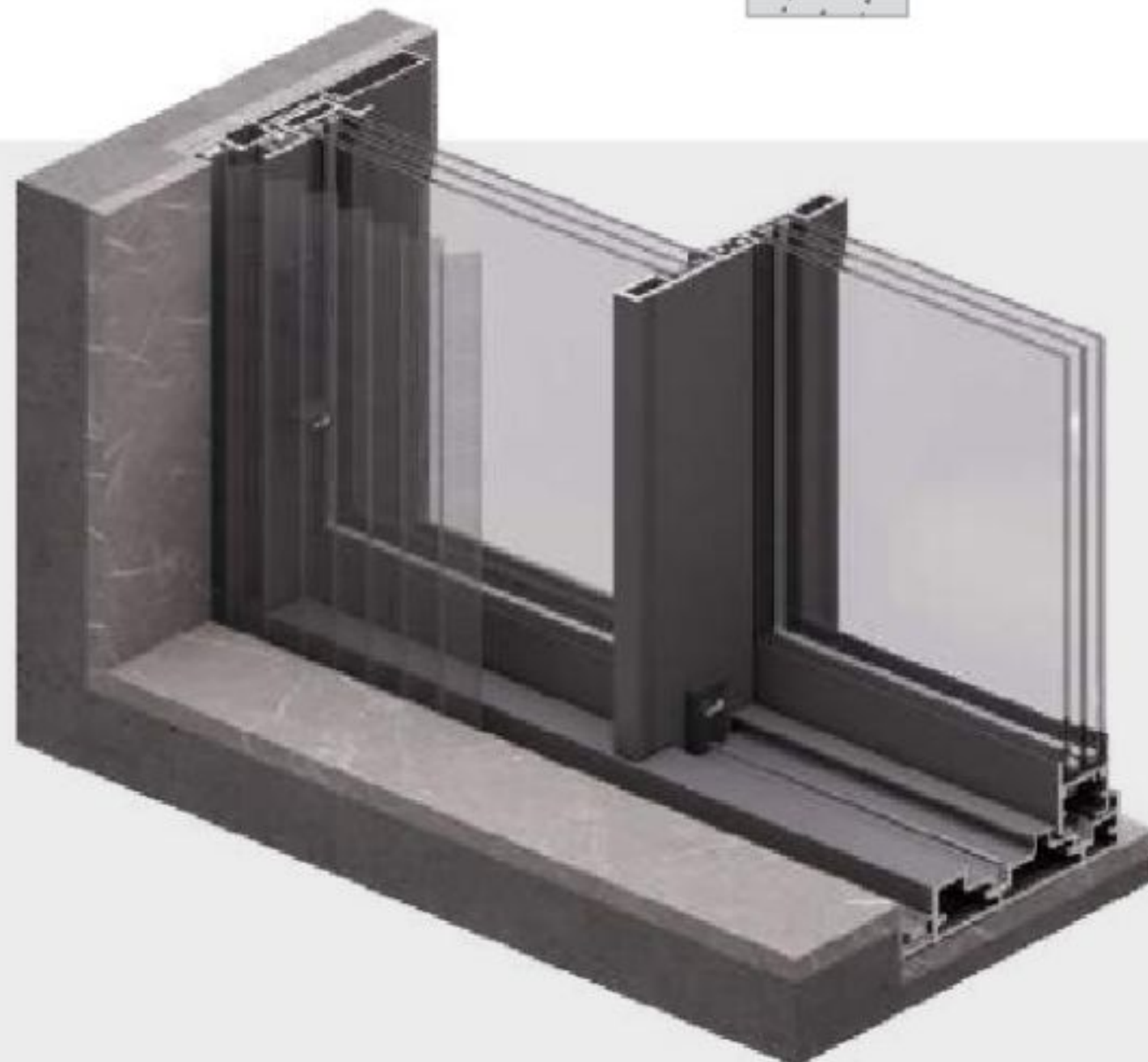

HL ELITE

GULF SLIM SYSTEM



HL ELITE GULF SLIM SYSTEM

Unyielding Strength, Uninterrupted Views: Our HL Elite Gulf Heavy Duty Slim System.

For projects demanding the ultimate in performance and elegance, HL Elite Gulf Heavy Duty Slim System stand unparalleled. Engineered for exceptional durability and resilience, these windows are designed to withstand the rigorous demands of large openings and challenging environments, making them ideal for high-end residences, commercial complexes, and luxury developments. While boasting robust, heavy-duty construction, we've retained our signature slim sightlines, ensuring that structural integrity never compromises your expansive, uninterrupted views. Experience the pinnacle of architectural fenestration, where superior strength, smooth operation, and sophisticated design converge to create windows that are truly built to last and impress.



Sound insulation



Water tightness



Wind load



Color choice



Impact resistance



10 years warranty

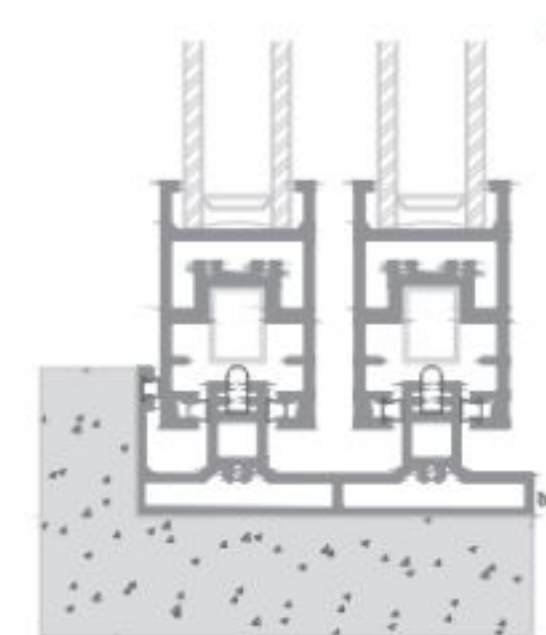
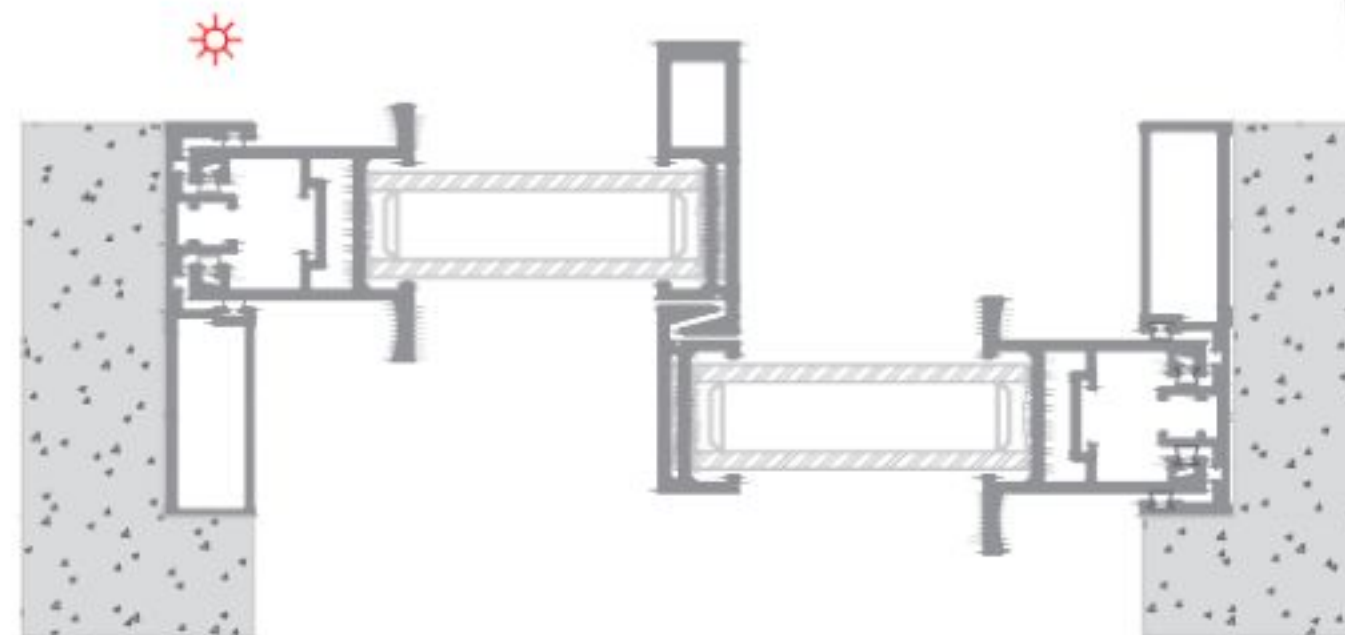

TECHNICAL SPECIFICATION

- ✦ 2 Track Frame Width : 108 MM
- ✦ 3 Track Frame Width : 161 MM
- ✦ Frame Height : 41 MM
- ✦ Interlock Sightline : 21 MM
- ✦ Glass Thickness : 10 MM To 28 MM
- ✦ Max. Shutter Height : 4000 MM
- ✦ Max. Shutter Width : 2100 MM
- ✦ Locking Type : Single / Multi Point Locking
- ✦ Mosquito Net : Shutter/Pleated
- ✦ Roller Capacity : Up to 250 Kg
- ✦ Wind Load Capacity : 2.8 KPA

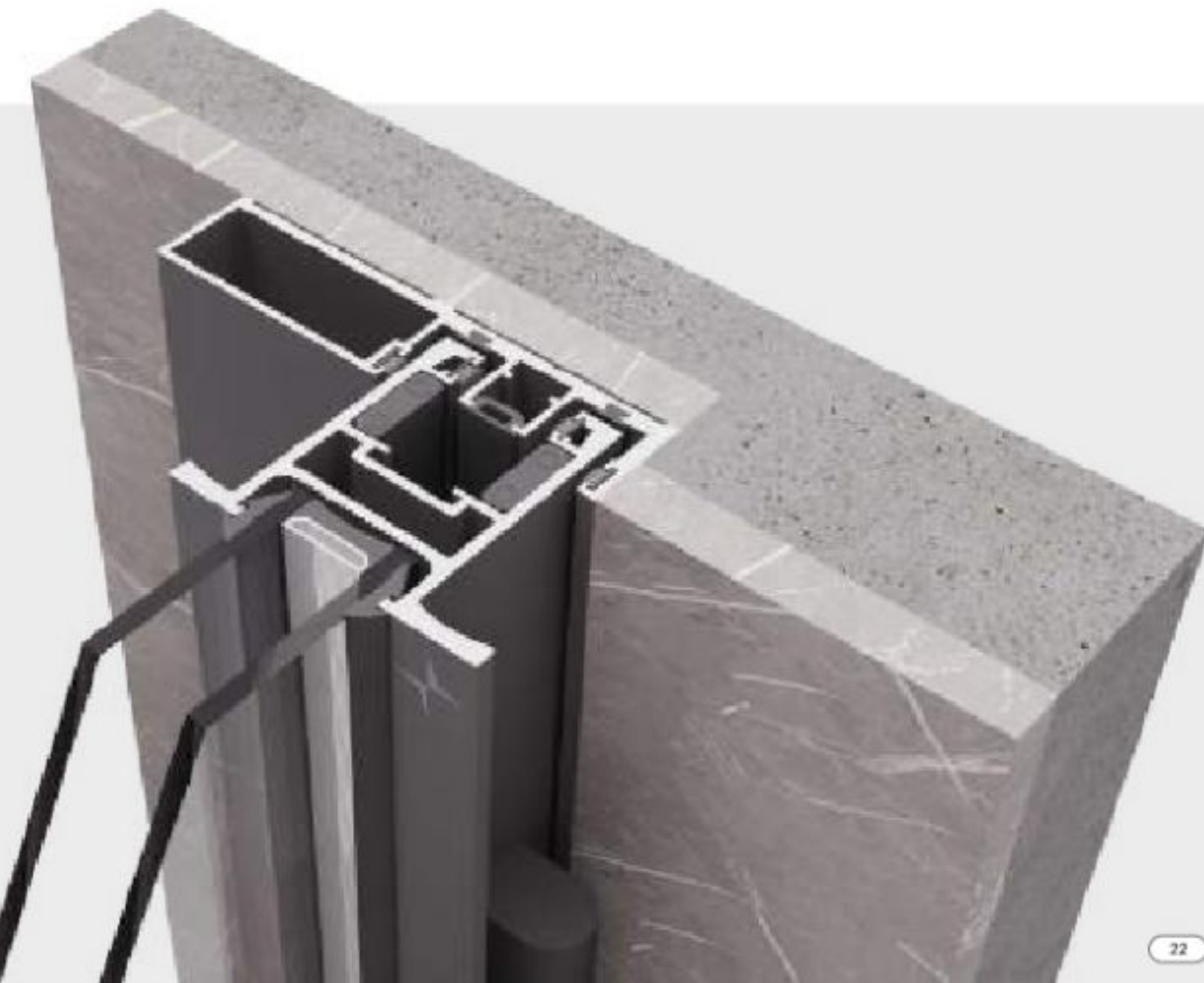
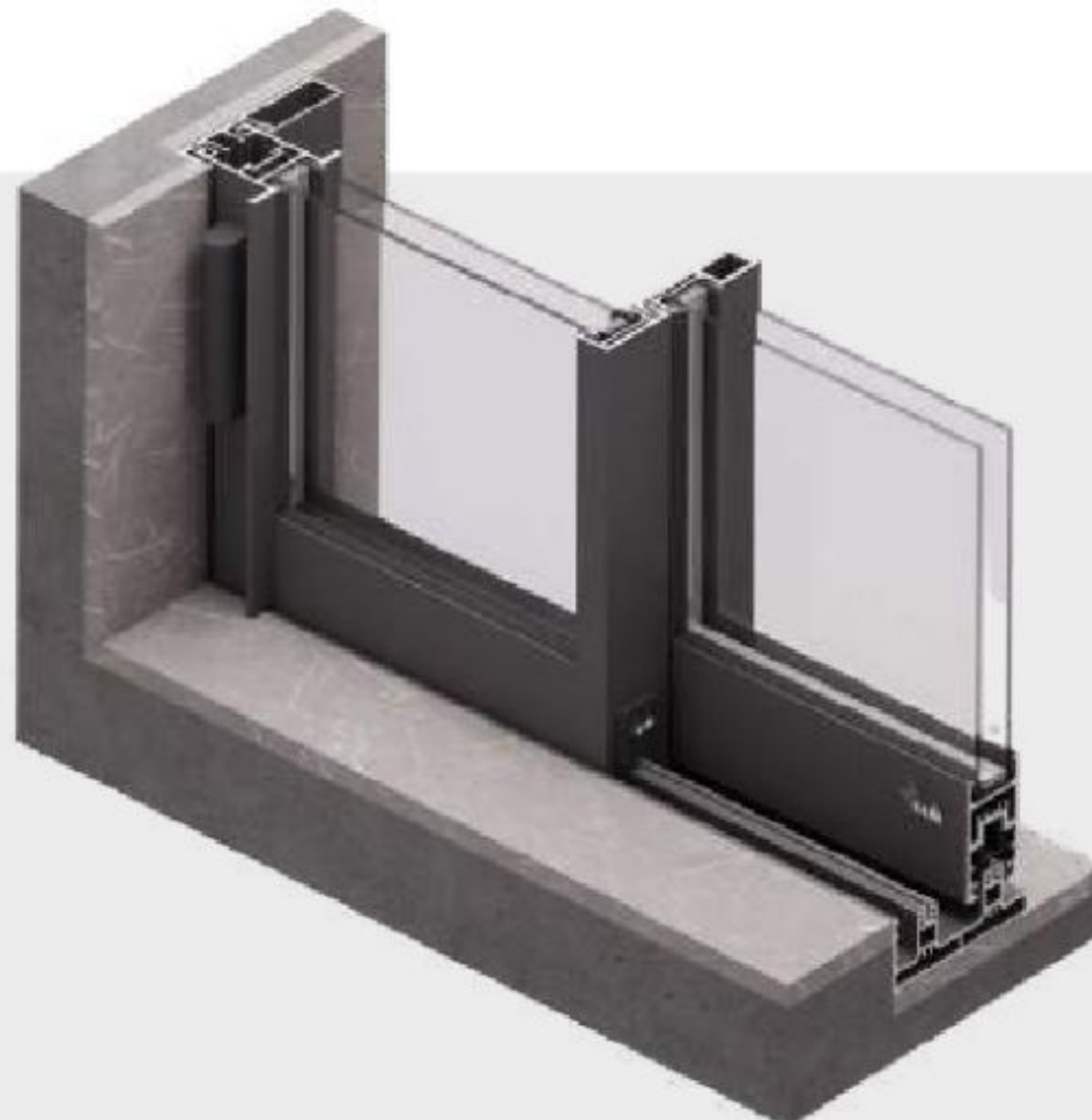

HL ULTRA
SLIM SYSTEM



HL ULTRA SLIM SYSTEM

Redefining Transparency: Our Ultra Slim System

Step into a new dimension of architectural brilliance HL Ultra Slim Sliding Windows. Designed to deliver the ultimate in minimalist aesthetics, these windows feature profiles so incredibly narrow, they virtually disappear, creating a stunning effect of **pure, uninterrupted glass**. Experience an unprecedented influx of natural light and breathtaking, panoramic views that seamlessly merge your indoor and outdoor living spaces. Perfect for contemporary homes and avant-garde designs in Surat, these windows embody modern sophistication, offering a truly invisible barrier that elevates your property with unparalleled elegance and openness.



Sound insulation



Water tightness



Wind load



Color choice



Impact resistance



10 years warranty

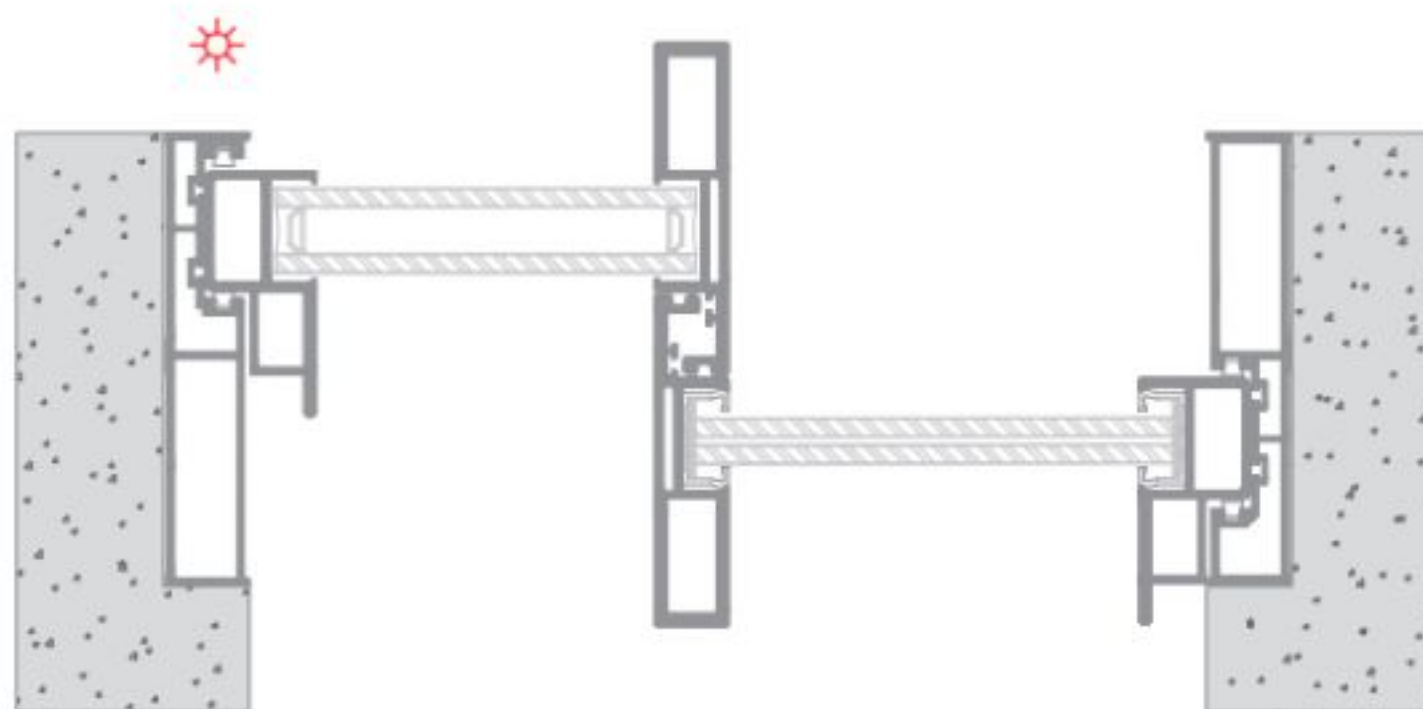

TECHNICAL SPECIFICATION

- ✦ 2 Track Frame Width : 118 MM
- ✦ 3 Track Frame Width : 173 MM
- ✦ Frame Height : 28 MM
- ✦ Interlock Sightline : 19 MM
- ✦ Glass Thickness : 5 MM To 20 MM
- ✦ Max. Shutter Height : 3600 MM
- ✦ Max. Shutter Width : 2000 MM
- ✦ Locking Type : Multi Locking (Top-Bottom)
- ✦ Mosquito Net : Pleated
- ✦ Roller Capacity : Up to 250 Kg
- ✦ Wind Load Capacity : 2 KPA

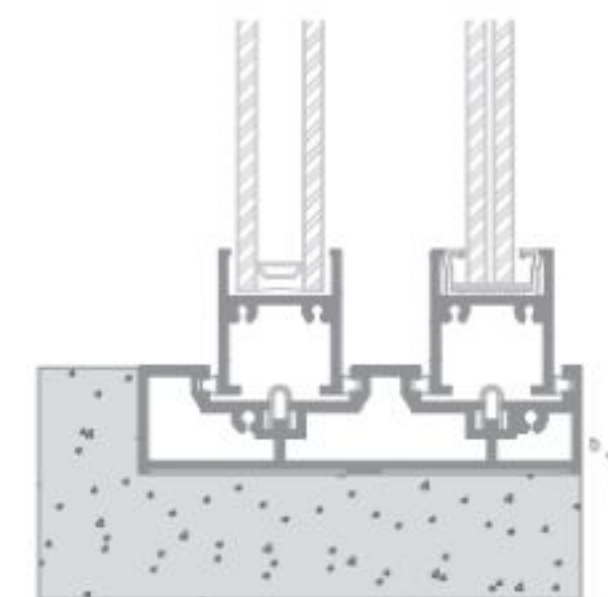

HL RETRO

GULF SLIM SYSTEM



HL RETRO GULF SLIM SYSTEM

Embrace Timeless Charm with Our HL RETRO GULF SYSTEM

Step into an era of classic elegance with HL RETRO GULF SYSTEM. Inspired by the rich architectural heritage of the Gulf region, these windows seamlessly blend vintage aesthetics with modern functionality. We've meticulously crafted these slim aluminium profiles to evoke the distinctive charm of traditional Gulf design, offering a unique visual appeal that stands out. Yet, beneath their timeless exterior lies the contemporary benefit of maximized natural light and unobstructed views thanks to their slender frames. Experience the perfect fusion of nostalgic beauty and durable, low-maintenance performance, bringing a touch of sophisticated, old-world character to your contemporary space.



Sound insulation



Water tightness



Wind load



Color choice



Impact resistance



10 years warranty

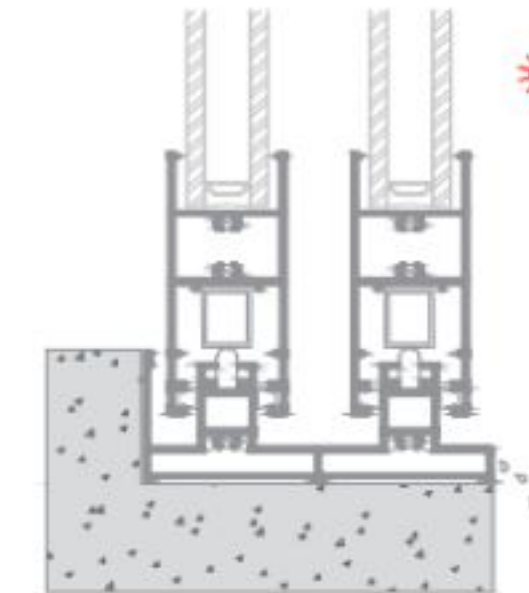
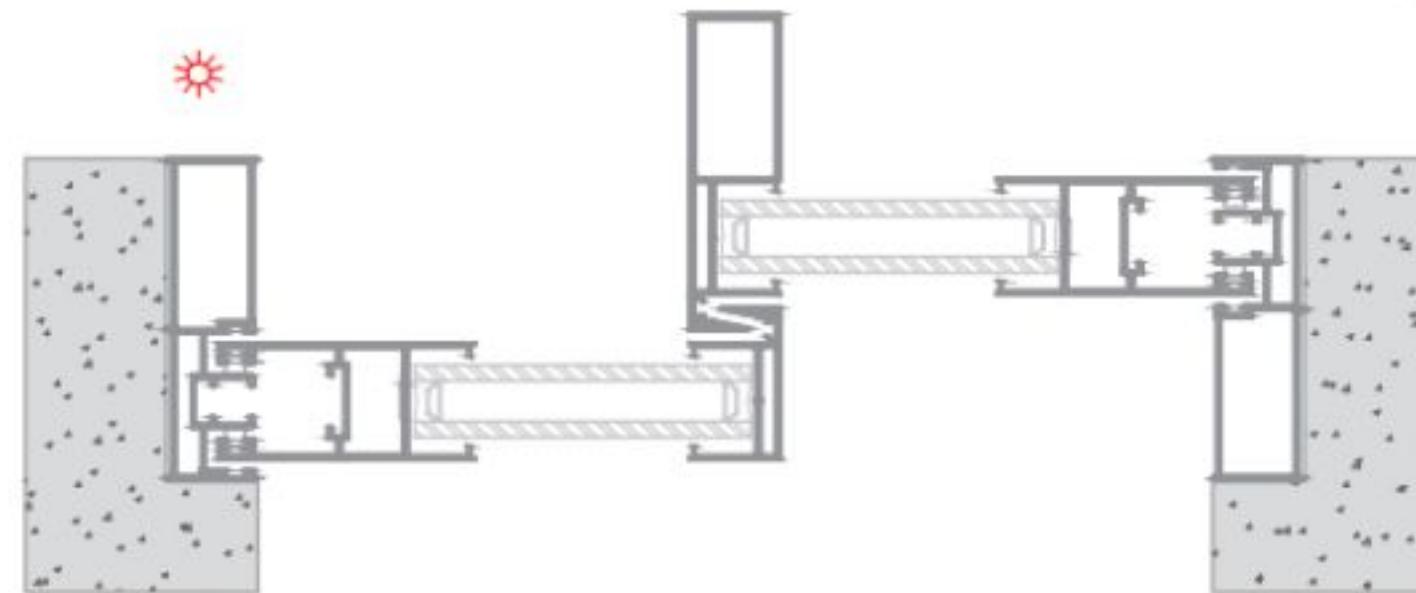

TECHNICAL SPECIFICATION

- ✦ 2 Track Frame Width : 100MM
- ✦ 3 Track Frame Width : 150MM
- ✦ Frame Height : 41 MM
- ✦ Interlock Sightline : 25 MM
- ✦ Glass Thickness : 5 MM To 23 MM
- ✦ Max. Shutter Height : 3500 MM
- ✦ Max. Shutter Width : 2000 MM
- ✦ Locking Type : Single / Multi Point Locking
- ✦ Mosquito Net : Shutter / Pleated
- ✦ Roller Capacity : Up to 120 Kg
- ✦ Wind Load Capacity : 1.8 KPA

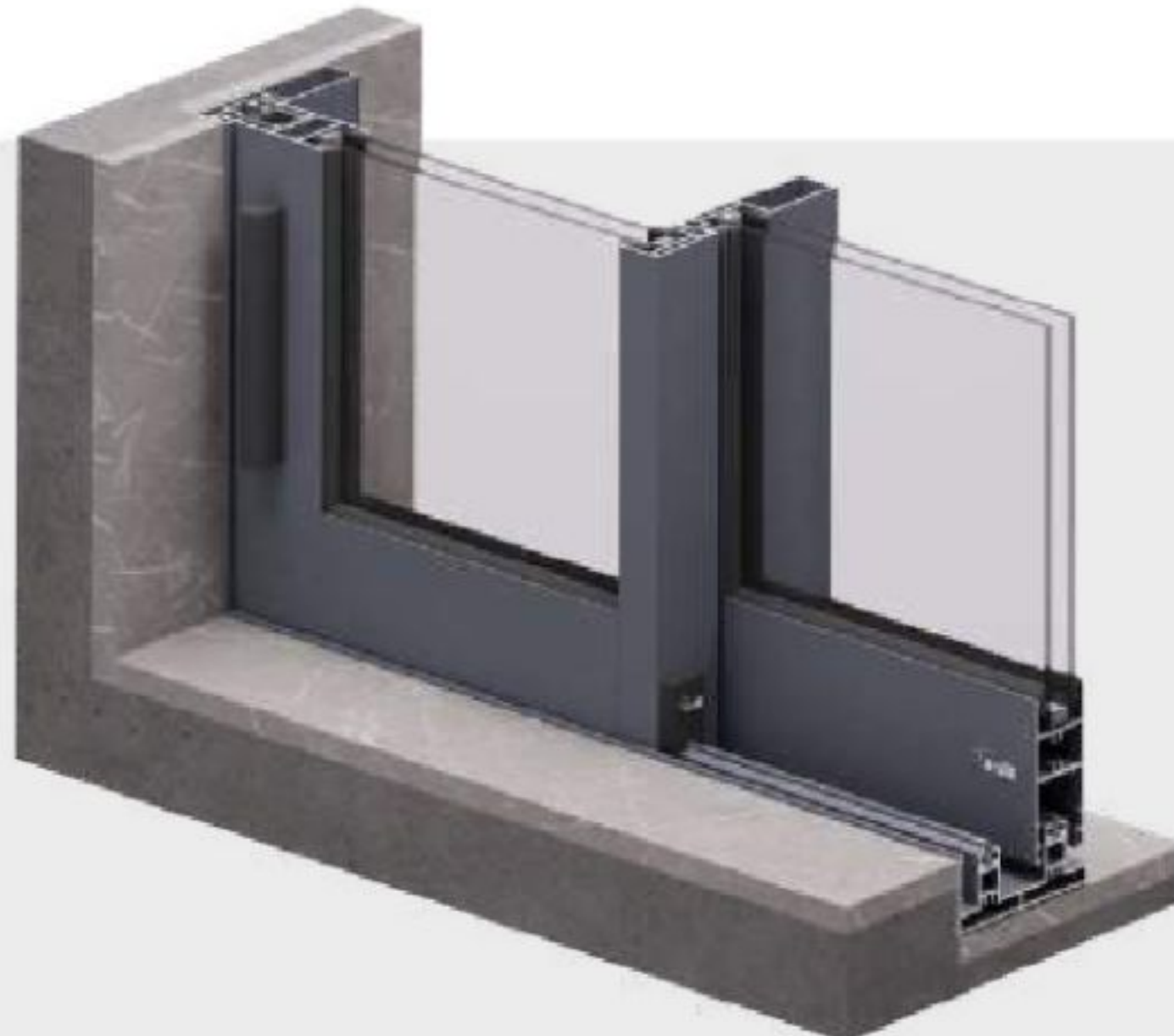

HL ECO

GULF SLIM SYSTEM



HL ECO GULF SLIM SYSTEM

Discover how to enhance your home's aesthetics & natural light without exceeding your budget with HL ECO GULF SYSTEM.

Designed specifically for the discerning homeowner, these windows offer the coveted sleek, minimalist look of slim interlock profiles, maximizing your views and inviting an abundance of daylight into your living spaces. Perfectly suited for our local climate. Enjoy the benefits of a modern, brighter home with smooth, reliable operation and long-lasting quality, making it a truly smart and affordable upgrade for any renovation or new construction project.



Sound insulation



Water tightness



Wind load



Color choice



Impact resistance



10 years warranty

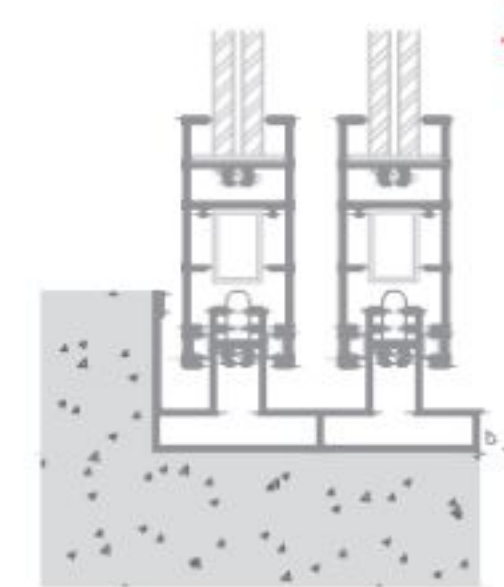
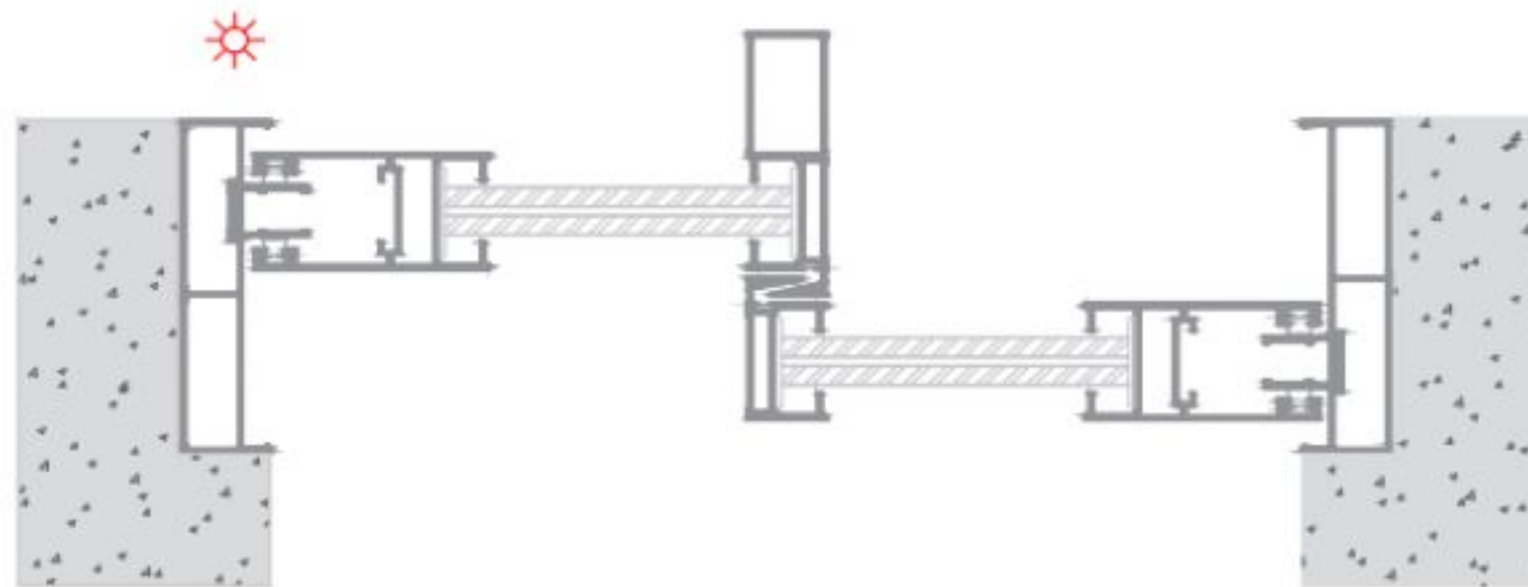

TECHNICAL SPECIFICATION

- ✦ 2 Track Frame Width : 83MM
- ✦ 3 Track Frame Width : 120MM
- ✦ Frame Height : 41 MM
- ✦ Interlock Sightline : 19 MM
- ✦ Glass Thickness : 5 MM To 11.5 MM
- ✦ Max. Shutter Height : 2100 MM
- ✦ Max. Shutter Width : 1200 MM
- ✦ Locking Type : Single / Multi Point Locking
- ✦ Mosquito Net : Shutter/Pleated
- ✦ Roller Capacity : Up to 80 kg
- ✦ Wind Load Capacity : 0.8 KPA



HL 50

CASEMENT DOOR



HL 50 CASEMENT DOOR

Grand Openings, Unyielding Performance: Our HL 50 Heavy-Duty Casement Door System

Introducing HL 50 Heavy Duty Casement Door System, meticulously engineered to transform standard door openings into statements of both elegance and robust functionality. Designed for larger apertures where strength and a grand opening are paramount, these casement doors provide an impressive alternative to traditional sliding or hinged doors. Crafted with **reinforced, heavy-gauge profiles and premium, high-performance hardware**, they ensure exceptional stability, superior security, and long-term durability against the elements, perfect for both residential and commercial applications. Experience effortless, wide-swing operation that seamlessly connects your indoor and outdoor spaces, offering expansive views and an opulent feel without compromising on an airtight seal and unyielding structural integrity.



Sound insulation



Water tightness



Wind load



Color choice



Impact resistance



10 years warranty

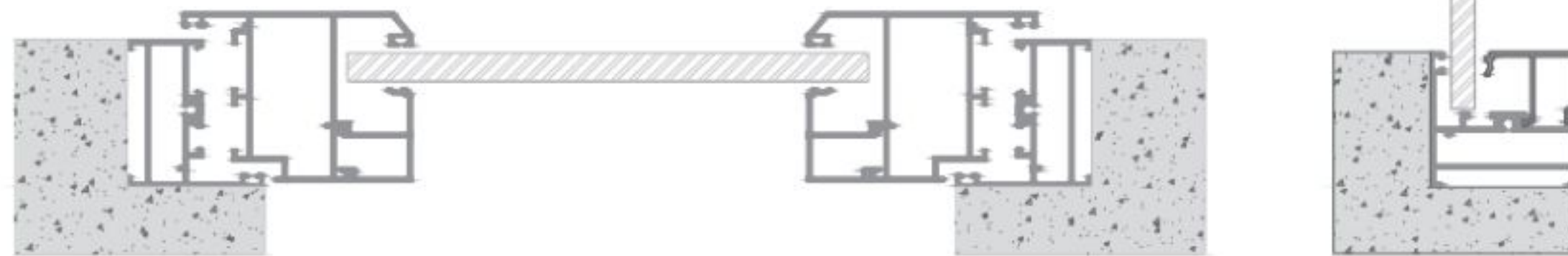

TECHNICAL SPECIFICATION

- ✦ Frame Width : 50 MM
- ✦ Frame Height : 46 MM
- ✦ Glass Thickness : 5 MM To 38 MM
- ✦ Max. Shutter Height : 2500 MM
- ✦ Max. Shutter Width : 1350 MM
- ✦ Locking Type : Multi / Single

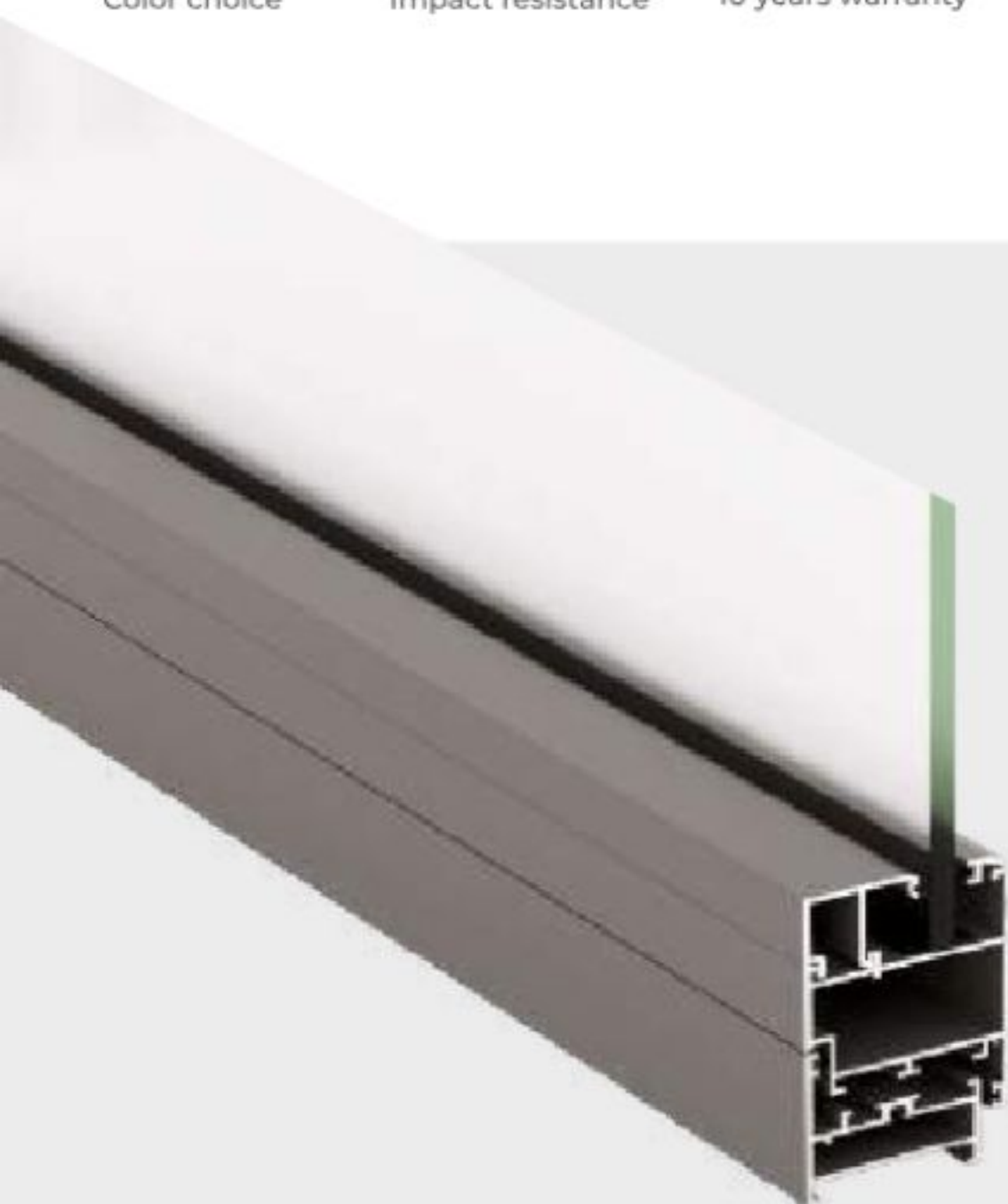

HL 40

CASEMENT WINDOW



HL 40 CASEMENT WINDOW

Smart Solutions for Compact Spaces: Our HL 40 Casement Window System

Optimize ventilation and light in even the smallest openings with HL 40 Casement Window System. Specially designed for compact spaces prevalent in modern urban living, these windows offer an ingenious solution where traditional sliding systems might not be feasible. Their **slender, lightweight design** ensures easy installation and effortless operation, allowing you to maximize airflow & bring in natural light with a simple swing. Ideal for kitchens, bathrooms, hallways, or any area with limited wall space, our casement windows provide **efficient ventilation, reliable security, and a neat, unobtrusive aesthetic**, proving that even small openings can deliver big on style and functionality.



Sound insulation



Water tightness



Wind load



Color choice



Impact resistance



10 years warranty

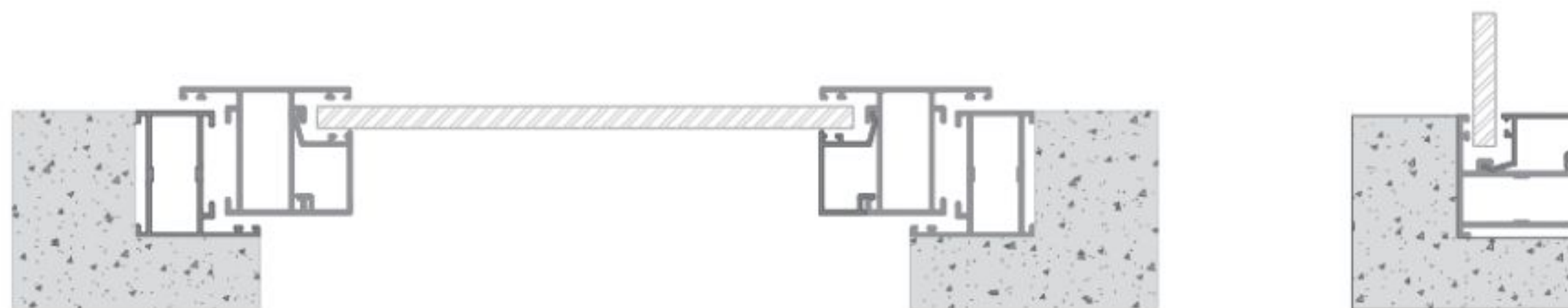

TECHNICAL SPECIFICATION

- ✦ Frame Width : 40 MM
- ✦ Frame Height : 39 MM
- ✦ Glass Thickness : 4MM To 24 MM
- ✦ Max. Shutter Height :1900 MM
- ✦ Max. Shutter Width : 700 MM
- ✦ Locking Type : Multi / Single



HL 2560

PARTITION SYSTEM



HL 2560 PARTITION SYSTEM

H LINE offers a wide variety of systems for the partitioning of interior spaces, ideal for offices, meeting rooms, banquet halls, etc.

Our system has minimal design and effective separation of interior spaces with high levels of sound insulation and aesthetics. The partitioning systems are available in standard and slim version, double or single glazed as well as in various typologies, providing complex applications and are compatible with glazed, aluminium/wood panels, etc. Our minimal partition system has sleek snap-fit sections, enabling easy assembly or change of glass, without creating any chasing in the floor or ceiling. It can be removed and re-installed at any other location without too much wastage. With our experience, H-LINE strives to design products which have a purpose and deliver exceptional results. Having in-house R & D team, all products are aesthetically designed and are technically acceptable, to turn your dreams into reality. We always want to facilitate the successful completion with timely execution of projects.



Sound insulation



Water tightness



Wind load



Color choice



Impact resistance



10 years warranty

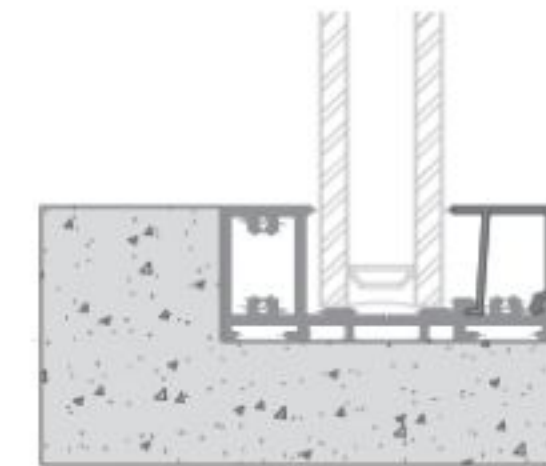
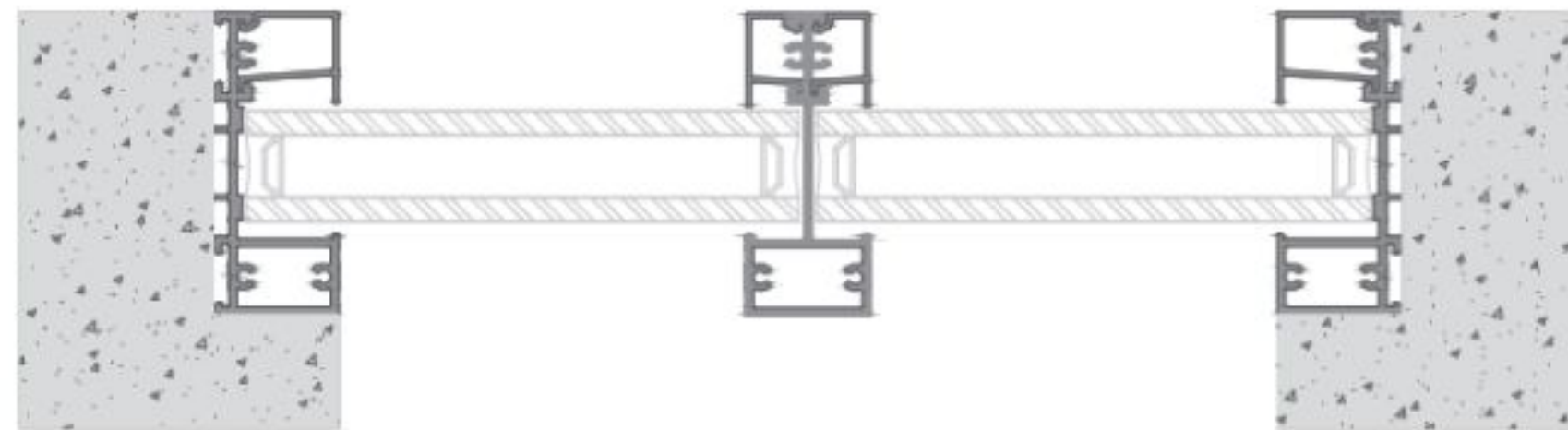

TECHNICAL SPECIFICATION

- ✦ Frame Width : 60 MM
- ✦ Frame Height : 25 MM
- ✦ Glass Thickness : 5 MM To 22 MM
- ✦ Door Sash : 55MM x 55MM



Sliding Folding System

Upgrade Your Space with the HL Bifold Sliding Folding System.



Bring a perfect balance of style, security, and smooth functionality to your interiors with the advanced HL Bifold Sliding Folding System.

Crafted with premium stainless-steel rollers, multi-point locking, and anti-burglary hinges, this system delivers effortless operation, long-lasting durability, and superior protection.

Whether for your home, office, or commercial space, the HL Sliding Folding System adds a modern, elegant touch while ensuring strength and performance that lasts.

- ✓ Smooth Sliding
- ✓ Robust Security
- ✓ Premium Durability

Specifications

- Shutter Width : 500-900 mm
- Shutter Height : 1,900-3,500 mm
- Frame Width : 80 mm
- Frame Height : 50 mm
- Load-bearing : ≤ 120 kg



Why Choose HL Bifold Sliding Folding System?

When it comes to combining modern design, advanced security, & smooth functionality, the HL Bifold Sliding Folding System stands out as the perfect choice.

Here's why

Effortless Operation

Premium stainless-steel rollers ensure smooth, quiet, and easy sliding, even with heavy loads.

Unmatched Security

Equipped with a multi-point lock body, shootbolt configuration, and anti-burglary hinge design for maximum protection.

Durability That Lasts

Built with wear-resistant materials, offering high load-bearing capacity and long service life.

Perfect Sealing

Small sealing strips ensure tight closure, keeping interiors safe, energy-efficient, and dust-free.

Modern Aesthetics

Sleek design adds elegance to any space—whether it's a luxury home, office, or commercial property.

Smart Engineering

Adjustable and fixed hinge options eliminate common installation issues like sash droop or over-adjustment.

A system built for strength, style, and long-term performance.

FEATURED PROJECTS



Client Testimonials



★★★★★

Thrilled with H-Line's facade work!
They transformed the exterior into a perfect blend
of aesthetics and functionality.

*Casa De Vida
Navsari*

“

★★★★★

Impressed by the quality! H-Line's window
and door solutions combine security
with a sleek, modern design.

*Pyramid Group
Surat*

”

★★★★★

H-Line's expertise in aluminum solutions—windows,
doors, and facades—sets new standards by delivering
both durability and modern appeal.

*KP Solar
Bharuch*

“

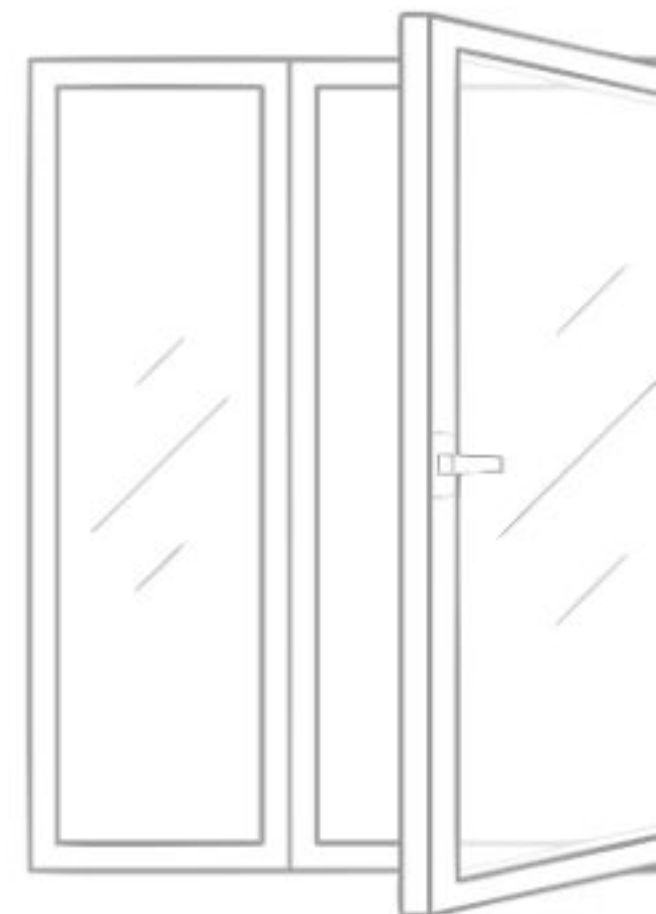



📍 Plot 80/A, Near Anthem Circle, Simada Canal Road Surat - 395006

🌐 www.hline.in

✉ info@hline.in

☎ +91 9081724244

📷 [hline_window_facade](https://www.instagram.com/hline_window_facade)